



World Scleroderma
Foundation

4TH SYSTEMIC SCLEROSIS WORLD CONGRESS

Final
Programme

FEBRUARY **18-20**, 2016
LISBON, PORTUGAL

www.sscworldcongress.org



Under the patronage of

Società Italiana
Reumatologia

Committees

Honorary Presidents

C Black, S Jablonska, F Wollheim, T Medsger

Steering Committee

DE Furst, L Guillevin, T Krieg, M Kuwana,
M Matucci-Cerinic, U Müller-Ladner, J Seibold,
K Takehara, A Tyndall, and the following Chairpersons:

1. Chairpersons of the Abstract Committee:
O Distler, P Sampaio Barros
2. Chairpersons of the Clinical Committee:
Y Allanore, D Khanna
3. Chairpersons of the Basic Science Committee:
J Distler, R Lafyatis, J Varga
4. Chairperson of the Workshops:
P Clements
5. Liaison officer with the Scleroderma Workshop:
C Denton, R Lafyatis
6. Chairpersons of the Mentoring Programme:
L Czirjak, M Mayes

Local Organising Committee

President of the Portuguese Society of Rheumatology:

Joao Eurico Cabral da Fonseca

Committee: **Ana Cordeiro (coordinator),**

Paulo Coelho, Catarina Resende, Maria João Salvador

Scientific Committee

D Abraham, Y Asano, S Assassi, J Avouac,
A Balbir-Gurmann, M Baron, M Becker, C Beyer,
PE Carreira, LJ Catoggio, C Chizzolini, M Cutolo,
N Damjanov, F Del Galdo, C Feghali-Botswick, C Ferri,
T Frech, A Gabrielli, S Gay, D Giuggioli, S Guiducci,
E Hachulla, A Herrick, M Hinchcliff, L Hummers,
M Inanc, B Kahaleh, S Kafaja, Y Kawaguchi, C Kayser,
R Knobler, O Kowal-Bielecka, D Launay, MT Li,
M Manetti, M Maurer, T Minier, G Moroncini, M Nikpour,
P Ostojic, J Pope, S Proudman, S Rednic,
G Riemekasten, L Sakkas, Y Shoenfeld, G Scuzs, A Shah,
R Simms, J Sindhu, V Steen, A Sulli, A Vacca,
F Van Den Hoogen, J Van Laar, M Vonk, A Wells

Fesca Board

Ann Tyrrell Kennedy, *President*

Beata Garay-Toth, *Vice-President*

Despo Charalambous-Demetriou, *Treasurer*

Alexandra Portales, *Secretary*

Annelise Roennow, *Counselor*

Kim Fligelstone, *Counselor*

Nadine Paciotti, *Counselor*

Joep Welling, *Counselor*

SCIENTIFIC PROGRAMME



THURSDAY, FEBRUARY 18

13:00-16:30 **Pre-meeting Workshops**

See information at page 11

16:45-17:45 **Satellite Symposia**

See information at page 14

18:00-18:30 **Opening Ceremony** **AUDITORIUM I**

Welcome addresses and opening remarks

18:30-20:10 **Opening Lectures** **AUDITORIUM I**

Chairpersons: **T Krieg (D)**, **D Furst (USA)**

18:30 What is new in basic research

C Denton (UK)

18:55 On the cutting edge of clinical investigations

T Medsger (USA)

19:20 Results and lessons from the main clinical trials in the last 2 years

D Khanna (USA)

19:50 Where do we stand with the early recognition of systemic sclerosis

M Matucci-Cerinic (I)

20:10 **Welcome Cocktail**

FRIDAY, FEBRUARY 19

08:00-09:10 **Session 1** **AUDITORIUM I**
PULMONARY INVOLVEMENT

**Chairpersons: A Wells (UK),
P Clements (USA)**

08:00 Mycophenolate versus oral cyclophosphamide
in scleroderma-related interstitial lung disease:
results of scleroderma lung study II
D Tashkin (USA)

08:25 ASSOCIATION BETWEEN SKIN GENE EXPRESSION AND
CLINICAL PHENOTYPE IN SYSTEMIC SCLEROSIS
M Hinchcliff, et al (USA)

08:40 INCIDENCES AND PREDICTORS OF ORGAN MANIFESTATIONS
IN THE EARLY COURSE OF SYSTEMIC SCLEROSIS: A
LONGITUDINAL EUSTAR STUDY
V Jaeger, et al (CH)

08:55 ANTIBODIES AGAINST CHEMOKINE RECEPTORS CXCR3 AND
CXCR4 AS MARKER FOR LUNG FIBROSIS IN PATIENTS WITH
SYSTEMIC SCLEROSIS
G Riemekasten, et al (D)

09:15-10:40 **Session 2** **AUDITORIUM I**
ULCERS
**Chairpersons: A Herrick (UK),
F Wigley (USA)**

09:15 Biology of Raynaud's phenomenon:
therapeutic implications
N Flavahan (USA)

09:40 VASCULAR HYPOTHESIS REVISITED: ROLE OF
STIMULATING ANTIBODIES AGAINST ANGIOTENSIN AND
ENDOTHELIN RECEPTORS IN THE PATHOGENESIS OF
SYSTEMIC SCLEROSIS
G Riemekasten, et al (D)

09:55 SENSITIVITY TO CHANGE OF NAILFOLD
VIDEOCAPILLAROSCOPY AND RELATIONSHIP WITH DISEASE
PROGRESSION
J Avouac, et al (F)

10:10 DIGITAL ULCERS IN SYSTEMIC SCLEROSIS: PREDICTOR
FACTORS
I Silva, et al (P)

10:25 PREVENTION OF DIGITAL ULCERS IN SYSTEMIC SCLEROSIS:
REAL LIFE DATA FROM THE DESSCIPHER OBSERVATIONAL
STUDY OF THE EUSTAR GROUP
J Blagojevic, et al (UK)

10:40-11:00 **Coffee break**

11:00 **Lecture 1** **AUDITORIUM I**
Chairpersons: E Hachulla (F), M Vonk (NL)
 Pulmonary arterial hypertension: the challenge
of screening for PAH in systemic sclerosis
N Galie (I)

11:25 **Oral presentation** **AUDITORIUM I**
 MACITENTAN RESPONSIVENESS SUPPORTS THE VALIDITY
OF A MURINE MODEL OF PULMONARY HYPERTENSION
IN SCLERODERMA ASSOCIATED WITH ALTERED TGF β /BMPRII
SIGNALLING
E Derret-Smith, et al (UK)

11:40 **Lecture 2** **AUDITORIUM I**
Chairpersons: P Carreira (E), C Ferri (I)
 Is there a role for Extracorporeal Photopheresis
(ECP) in Systemic Sclerosis?
R Knobler (A)
*Sponsored by Therakos
(now a part of Mallinckrodt)*

12:15-13:45 **Satellite Symposia**
 See information at page 14

13:45-14:45 **Poster session & lunch break**

14:45-15:25 **Satellite Symposia**

See information at page 14

15:30-16:55 **Parallel Session 3** **AUDITORIUM I**
COMMON CLINICAL SITUATIONS WITH
POOR EVIDENCE BASED DATA: HOW TO
MANAGE?

Chairpersons: T Frech (USA),
F van den Hoogen (NL)

15:30 Pregnancy & sexual problems

V Steen (USA)

15:55 IMPRESS-2 (INTERNATIONAL MULTICENTRIC PROSPECTIVE
 STUDY ON PREGNANCY IN SYSTEMIC SCLEROSIS).
 PROSPECTIVE, CASE-CONTROL STUDY OF PREGNANCY IN
 SYSTEMIC SCLEROSIS

M Betelli, et al (I)

16:05 Dental issues in scleroderma - SICCA,
 mandibular reabsorption, orthodontist issues
 and how many manage as a rheumatologist

D Leader (USA)

16:30 Scleroderma patient admitted to ICU - what
 should a rheumatologist be aware of and
 interaction with the ICU physicians

F Pene (F)

15:30-16:55 **Parallel Session 4** **AUDITORIUM III**
ADVANCES IN EPIGENETICS
AND GENETICS

Chairpersons: J Distler (D), B Lafyatis (USA)

15:30 Epigenetic control of fibrogenesis and
 transgenerational epigenetic adaption of the
 wound healing response

D Mann (UK)

15:55 INHIBITION OF PHOSPHODIESTERASE 4 (PDE4) REDUCES
 DERMAL FIBROSIS BY INTERFERING WITH THE RELEASE OF
 PRO-FIBROTIC CYTOKINES FROM M2-MACROPHAGES

C Maier, et al (D)

16:10 EPITHELIAL FLI1 DELETION INDUCES FIBROSIS AND
 AUTOIMMUNITY WITH DOWNREGULATION OF AIRE -
 POSSIBLE ROLES IN SYSTEMIC SCLEROSIS PATHOGENESIS

Y Asano, et al (JPN)

16:25 ENDOTHELIAL-TO-MESENCHYMAL TRANSITION (ENDOMT)
 AS A KEY PROFIBROTIC SWITCH IN SYSTEMIC SCLEROSIS

M Manetti, et al (I)

16:40 WNT/PCP-SIGNALING AS A β -CATENIN INDEPENDENT
 PATHWAY TO PROMOTE FIBROBLAST ACTIVATION IN
 SYSTEMIC SCLEROSIS

C Chen, et al (D)

16:55-17:15 **Coffee break**

17:15-19:10 **Parallel Session 5** **AUDITORIUM I**
CARDIAC

Chairpersons: N Damjanov (SR),
S Assassi (USA)

17:15 Cardiac involvement in systemic sclerosis.
 What should be known by the practitioners

A L Caforio (I)

17:40 INFLAMMATORY CELLS AND STROMAL SUB-POPULATIONS
 INVOLVEMENT IN THE MYOCARDIAL FIBROGENESIS IN
 SYSTEMIC SCLEROSIS

M Stellato, et al (CH)

- 17:55 N-TERMINAL PRO BRAIN NATRIURETIC PEPTIDE IS A STRONG PREDICTOR OF MORTALITY IN SYSTEMIC SCLEROSIS
J Avouac, et al (F)
- 18:10 CARDIAC BIOMARKERS IN PRIMARY HEART INVOLVEMENT IN SYSTEMIC SCLEROSIS: NT- PROBNP AND TROPONIN T AS DIAGNOSTIC AND PROGNOSTIC BIOMARKERS
S Bosello, et al (I)
- 18:25 PROGNOSTIC ROLE OF VENTRICULAR ECTOPIC BEATS IN SYSTEMIC SCLEROSIS
S Bosello, et al (I)
- 18:40 EARLY DETECTION OF CARDIAC INVOLVEMENT BY MAGNETIC RESONANCE: CLINICAL CORRELATIONS IN SYSTEMIC SCLEROSIS
L Gargani, et al (I)
- 18:55 IMAGING PATTERNS OF STRESS PERFUSION-FIBROSIS IN SYSTEMIC SCLEROSIS USING CARDIOVASCULAR MAGNETIC RESONANCE
S Mavrogeni, et al (GR)
- 17:15-19:10 **Parallel Session 6** **AUDITORIUM III**
CURRENT RESEARCH IN IMMUNITY/ INFLAMMATION
Chairpersons: D Abraham (UK), J Varga (USA)
- 17:15 Regulatory T cells, macrophage-derived leukotriene B4 and the evolution of pulmonary hypertension
M Nicolls (USA)
- 17:40 PAN PPAR AGONIST IVA337 IS EFFECTIVE IN PREVENTION AND TREATMENT OF EXPERIMENTAL SKIN FIBROSIS
Y Allanore, et al (F)
- 17:55 MULTI-ORGAN SYSTEMS BIOLOGY ANALYSIS OF SYSTEMIC SCLEROSIS REVEALS A MACROPHAGE SIGNATURE ASSOCIATED WITH DISEASE SEVERITY IN MULTIPLE END-TARGET TISSUES
M Whitfield, et al (USA)
- 18:10 INNATE LYMPHOID CELLS – NEW PLAYERS IN SYSTEMIC SCLEROSIS CORRELATE WITH EXTENT OF SKIN AND LUNG FIBROSIS
T Wolfahrt, et al (D)
- 18:25 TIE2 AS A NOVEL FACTOR OF PERIPHERAL MICROANGIOPATHY IN SYSTEMIC SCLEROSIS
B Maurer, et al (CH)
- 18:40 THE ROLE OF IL-17 CYTOKINE FAMILY MEMBERS IN SCLERODERMA SKIN
C Chizzolini, et al (CH)
- 18:55 ESTROGENS INHIBIT THE PROFIBROTIC EFFECTS OF TGF-BETA AND PROTECT FROM THE DEVELOPMENT OF EXPERIMENTAL DERMAL FIBROSIS
J Avouac, et al (F)

SATURDAY, FEBRUARY 20

08:00-09:00 **Session 7** **AUDITORIUM I**
MEET THE PROFESSOR SESSIONSAutoantibodies: Practical **ROOM 1.02**

Implications for Diagnosis & Prognosis

T Medsger (USA) & O Distler (CH)PAH versus PH: **ROOM 1.03**

Why the difference matters

V Steen (USA) & C Denton (UK)SSc ILD: Stable **ROOM 1.04**

vs Progressive Disease: To treat or not to treat

G Riemekasten (D) & D Tashkin (USA)Cardiac: Practical Guide **ROOM 1.05**

to Screening and Evaluation

Y Allanore (F) & U Müller-Ladner (D)GI: GERD/GAVE and Small Bowel **ROOM 1.06****D Khanna (USA) & J Clarke (USA)**MSK: Evaluation of the “puffy hand” **ROOM 1.07**

arthritis vs tenosynovitis

P Clements (USA) & M Mayes (USA)Digital ulcers: evaluation, treatment **ROOM 1.08**

and pain management

M Matucci-Cerinic (I) & F Wigley (USA)Progressive skin disease **ROOM 1.11**

– approach to evaluation and management

D Furst (USA) & L Czirjak (H)09:05 **Lecture 3** **AUDITORIUM I****Chairpersons: B Kahaleh (USA), A Gabrielli (I)**

Anti-RNA polymerase III antibody: from its discovery to utility in clinical practice and basic research

M Kuwana (JPN)09:30 **Oral Presentation** **AUDITORIUM I**

INCREASED FREQUENCY OF MALIGNANCIES, AND IN PARTICULAR BREAST CANCER, SYNCHRONOUS TO THE ONSET OF SYSTEMIC SCLEROSIS IN ANTI-RNA POLYMERASE III ANTIBODIES POSITIVE PATIENTS: A EUSTAR MULTICENTRE STUDY

M Lazzaroni, et al (I)09:40 **Lecture 4** **AUDITORIUM I****Chairpersons: U Müller-Ladner (D),****L Hummers (USA)**

Upper and lower gastrointestinal/nutrition

J Clarke (USA)10:05 **Oral Presentation** **AUDITORIUM I**

IMPAIRED MICRONUTRIENT STATUS IN PATIENTS WITH SYSTEMIC SCLEROSIS

R Dobrota, et al (CH)10:20-10:40 **Coffee break**10:40-12:00 **Session 8** **AUDITORIUM I****ROUND TABLE SSC REGISTRIES**
IN THE WORLD**Chairpersons: M Mayes (USA), T Krieg (D)**10:40 **Y Allanore** introducing EUSTAR and PHENOTYPES DETERMINED BY CLUSTER ANALYSIS AND THEIR SURVIVAL IN THE PROSPECTIVE EUSTAR COHORT OF PATIENTS WITH SYSTEMIC SCLEROSIS**V Sobanski, et al (F)**

- 10:55 **T Krieg** introduces DSNW and
 LOW FREQUENCY OF RENAL CRISIS IN MORE THAN 3100
 PATIENTS OF THE GERMAN NETWORK FOR SYSTEMIC
 SCLERODERMA (DNSS)
N Hunzelmann, et al (D)
- 11:10 **M Baron** introduces Canadian network and
 GUIDELINES FOR THE RATIONAL USE OF FOLLOW-
 UP CARDIAC ECHOCARDIOGRAPHY TO SCREEN FOR
 PULMONARY ARTERIAL HYPERTENSION (PAH) IN SYSTEMIC
 SCLEROSIS (SSC)
M Baron, et al (CND)
- 11:25 **S Proudman** Introduces the Australian registry and
 DETERMINANTS OF UNEMPLOYMENT AMONGST
 AUSTRALIAN SCLERODERMA PATIENTS: RESULTS FROM A
 LARGE MULTICENTRE COHORT STUDY
K Morrisroe, et al (AUS)
- 11:40-12:00 Discussion
- 12:00 **Lecture 5** AUDITORIUM I
Chairpersons: L Czirjak (H),
S Proudman (A)
 LcSSc the unfairly neglected subset
 of systemic sclerosis?
Y Allamore (F)
- 12:25 **Oral Presentation** AUDITORIUM I
 SURVIVAL AND ORGAN INVOLVEMENT IN PATIENTS
 WITH LIMITED CUTANEOUS SYSTEMIC SCLEROSIS AND
 ANTI-TOPOISOMERASE ANTIBODIES: MORE LIKE LIMITED
 CUTANEOUS OR MORE LIKE DIFFUSE CUTANEOUS
 SYSTEMIC SCLEROSIS?
P Kranenburg, et al (NL)
- 12:40-13:30 **Poster session & lunch break**
- 13:30-14:45 **Parallel Session 9** AUDITORIUM III
EXPERIMENTAL MODELS
OF SCLERODERMA
Chairperson: P Coelho (P),
F del Galdo (UK)
- 13:30 UPAR-DEFICIENT MICE: A NOVEL EXPERIMENTAL MODEL
 OF DELAYED CUTANEOUS WOUND HEALING TO EXPLORE
 SYSTEMIC SCLEROSIS-RELATED DIGITAL ULCERS
S Kotzki, et al (F)
- 13:40 GLI2 AS A TARGET FOR ANTIFIBROTIC THERAPIES IN
 PRECLINICAL MODELS OF SYSTEMIC SCLEROSIS
J Distler, et al (D)
- 13:50 SMALL PEPTIDES DERIVED FROM MET RECEPTOR
 TYROSINE KINASE AS NEW THERAPEUTIC APPROACH FOR
 THE TREATMENT OF SCLERODERMA
G Bogatkevich, et al (USA)
- 14:00 CM-101, A NOVEL MONOCLONAL ANTIBODY BLOCKING
 CCL24 AMELIORATES EXPERIMENTAL SYSTEMIC SCLEROSIS
 (SSC) AND IDIOPATHIC PULMONARY FIBROSIS (IPF) **and**
 A NOVEL ANTIBODY BLOCKING CCL24/CCR3 REDUCES
 CHEMOKINESIS OF IMMUNE CELLS AND THE TRANSITION
 OF FIBROBLASTS TO MYOFIBROBLASTS IN SYSTEMIC
 SCLEROSIS (SSC)
A Mor, et al (ISR)
- 14:15 EFFECTS OF NINTEDANIB ON FIBROTIC AND VASCULAR
 MANIFESTATIONS IN PRECLINICAL MODELS OF SYSTEMIC
 SCLEROSIS
J Distler, et al (D)
- 14:25 M2-SHIFTED MICE RECAPITULATE DERMAL AND
 PULMONARY REMODELING
H Yassoka, et al (JPN)

14:35 NOX4 IS A CRUCIAL MEDIATOR OF TGF-BETA1-INDUCED FIBROBLAST ACTIVATION OF DERMAL FIBROBLASTS
- NOVEL FINDINGS FROM IN VITRO AND IN VIVO SCLERODERMA RESEARCH
M Bohm, et al (D)

14:30 FROM VEDOSS TO ESTABLISHED SYSTEMIC SCLEROSIS DIAGNOSIS ACCORDING TO THE NEW ACR/EULAR 2013 CLASSIFICATION CRITERIA: A CAPILLAROSCOPIC SURVEY
M Vasile, et al (I)

13:30-14:40 **Parallel Session 10** **AUDITORIUM I**
OUTCOME MEASURES
Chairpersons: **E Kucharz (PL), S Johnson (CND)**

14:45-16:10 **Session 11** **AUDITORIUM I**
EMERGING THERAPIES
Chairpersons: **K Takehara (JPN), J Seibold (USA)**

13:30 PREDICTION OF IMPROVEMENT IN SKIN FIBROSIS IN DIFFUSE CUTANEOUS SYSTEMIC SCLEROSIS - A EUSTAR ANALYSIS
R Dobrota, et al (CH)

14:45 Emerging therapies
O Distler (CH)

13:40 DEVELOPMENT OF A DISEASE DAMAGE INDEX IN SYSTEMIC SCLEROSIS USING CONSENSUS AND DATA DRIVEN METHODS
N Ferdowski, et al (AUS)

15:10 EFFICACY OF MYCOPHENOLATE MOFETIL (MMF) VERSUS ORAL CYCLOPHOSPHAMIDE (CYC) ON SKIN THICKNESS IN THE SCLERODERMA LUNG STUDY II
D Khanna, et al (USA)

13:50 EUSTAR TASK FORCE FOR THE DEVELOPMENT OF A REVISED ACTIVITY CRITERIA FOR SYSTEMIC SCLEROSIS
M Iudici, et al (I)

15:25 BASELINE CHARACTERISTICS AND TREATMENT CHOICES IN PATIENTS WITH EARLY DIFFUSE CUTANEOUS SYSTEMIC SCLEROSIS (ESOS COHORT)
A Herrick, et al (UK)

14:00 COMPLEMENTARY VALUE OF ELF TEST AND NT-PROBNP IN REFLECTING FIBROSIS AND VASCULOPATHY IN SYSTEMIC SCLEROSIS
G Abignano, et al (UK)

15:40 INHIBITION OF MYELOID-ASSOCIATED GENE EXPRESSION IN SKIN BIOPSY SAMPLES OF SYSTEMIC SCLEROSIS PATIENTS TREATED WITH TOCILIZUMAB
R Lafyatis, et al (USA)

14:10 THE SCLERODERMA FIBROTIC SCORE: A USEFUL SERUM TEST IN THE DIAGNOSIS OF EARLY SCLERODERMA
J Blagojevic, et al (UK)

15:55 TREATING SCLERODERMA OF THE FACE AND HANDS WITH FAT AND STROMAL VASCULAR FRACTION
G Magalon, et al (F)

14:20 VERY EARLY AND EARLY SYSTEMIC SCLEROSIS PATIENTS IN THE SPANISH SCLERODERMA REGISTRY (RESCLE) COHORT
L Trapiella, et al (E)

16:15-16:55 **Closing Lectures** **AUDITORIUM I**
Chairpersons: **A Balbir-Gurmann (ISR), JE Cabral da Fonseca (P)**

16:15 New EULAR recommendations for the treatment of systemic sclerosis
O Kowal-Bielecka (PL)

SCIENTIFIC PROGRAMME

SATURDAY, FEBRUARY 20

16:35 Review of the most relevant works presented at
the congress
D Furst (USA)

16:55-17:00 Closure of the congress

WORKSHOP PROGRAMME



Workshops will be held on **Thursday, February 18**.
90 minutes workshops will be repeated twice,
180 minutes workshops all at once.

Reservation is requested.
Left places can be booked at the “New Registration”
desk in the registration area.

Coordinator: Phil Clements (USA)

90 minutes workshops

The following 90 minutes workshops will be held twice:

From 13:00 to 14:30 first slot and
From 15:00 to 16:30 second slot

How to take skin biopsies **ROOM 1.02**
Convenors: O Distler (CH), C Beyer (D)

Skin scoring **ROOM 1.07**
**Convenors: P Clements (USA), L Czirjak (H),
D Furst (USA), M Mayes (USA)**

13:00-13:15 / 15:00-15:15 Why do the skin score?
13:15-13:30 / 15:15-15:30 How to do the skin score
13:30-14:30 / 15:30-16:30 Skin scoring -hands on skin
scoring of 3 patients

**Risk Assessment for ILD in patients
with Systemic Sclerosis** **ROOM 1.05**
Convenor: R Saggar (USA)

The local management of digital ulcers **ROOM 1.06**
Convenor: M Matucci-Cerinic (I)

13:00/15:00 DU in systemic sclerosis: from clinical
evidence to treatment
M Matucci-Cerinic (I)

13:15/15:15 The management of DU infections in
systemic sclerosis
D Giuggioli (I)

13:30/15:30 Hands on work on 3 patients
F Braschi (I), M Niederer-Spinazzè (CH)

180 minutes workshops

The following 180 minutes workshops will be held from 13:00 to 16:30 – one slot only

Capillaroscopy 2016: UP TO DATE **ROOM 3A**
Convenor: M Cutolo (I)

13:00 Capillaroscopy 2016: a true diagnostic tool
M Cutolo (I)

13:10 Capillaroscopy only hot in Raynauds and systemic sclerosis or also important throughout other connective tissue diseases?
A L Herrick (UK)

13:40 How to distinguish the pathological capillaroscopic patterns from a normal pattern and role in prediction of clinical complications in systemic sclerosis
V Smith (B)

14:10 Reliability of qualitative and quantitative capillaroscopic assessment: links with peripheral blood flow and skin fibrosis
A Sulli (I)

14:40 **Coffee break**

15:10 What's new: Capillaroscopy and other microcirculatory tools in assessment of therapies in Rheumatic diseases: where are we and where do we head at?
M Cutolo (I)

15:40 Q&A

15:50 Capillaroscopy on living cases
All tutors

Localized scleroderma Diagnosis, Classification and Therapy **ROOM 1.03**

Convenors: R Knobler (A), T Krieg (D), K Takehara (JPN)

13:00 Introduction
T Krieg (D)

13:05 Pseudosclerodermatous diseases. How to make a diagnosis
F Rongioletti (I)

13:25 Classification of localized scleroderma and the European approach
P Moinzadeh (D)

13:35 Classification of localized scleroderma the US experience
H Jacobe (USA)

13:45 Lessons from the Japanese registry
Y Asano (JPN)

13:55 Discussion

14:05 Selected case presentations diagnostic challenges
A Kreuter (D), L Rudnicka (PL)

14:30 **Coffee Break**

15:00 Topical and UV-associated therapy of localized scleroderma
R Knobler (A)

15:20 Systemic therapies
J Seneschal (F)

15:40 Selected case presentations
 difficult treatment decisions
I Foeldvari (D), P Moinzadeh (D)

16:05 New therapeutic developments based on
 pathophysiological concepts
N Hunzelmann (D)

16:25 Summary
K Takehara (JPN)

Quantitative scoring of HRCT

Convenor: J Goldin (USA)

Outline:

- 1 Review of ct findings in SLD
- 2 Visual and quantitative measures and role in prediction and outcome
- 3 Visual scoring techniques
 - 1 quick disease extent (wells)
 - 2 semi quantitative by lobe and component
- 4 Training cases
- 5 Test cases
- 6 Review of test cases

ROOM 1.04

Ultrasound in systemic sclerosis; Improving its management in clinical practice

Convenor: E Naredo (E)

ROOM 1.08

13:00 Welcome
 Clinical case
E Naredo (E)

13:05 Anatomic basis for musculoskeletal
 involvement in systemic sclerosis
I Möller (E)

13:30 Joint inflammation (i.e. synovitis and
 tenosynovitis) in systemic sclerosis;
 Do we need ultrasound?
A Iagnocco (I)

13:55 How can ultrasound help in lung
 involvement?
L Gargani (I)

14:30 **Coffee break**

15:00 Workshop on joints and lung
 in systemic sclerosis

SATELLITE SYMPOSIA



BAYER SATELLITE SYMPOSIUM

AUDITORIUM I

Thursday, February 18
16:45-17:45

SGC STIMULATION – AN INNOVATIVE TREATMENT OPTION IN MANAGEMENT OF PAH-CTD

Chairperson: **G Riemekasten (D)**

Welcome and introduction
G Riemekasten (D)

16:50 sGC stimulation:
Understanding the mode of action
J Distler (D)

17:00 Screening for and diagnosing PAH
in systemic sclerosis patients
D Khanna (USA)

17:10 sGC stimulation in PAH-CTD patients:
Results from the PATENT studies
C Denton (UK)

17:20 Updated EULAR guidelines for the treatment of
systemic sclerosis: What does it mean for PAH-CTD?
O Kowal-Bielecka (PL)

17:30 Discussion

ACTELION SATELLITE SYMPOSIUM

AUDITORIUM I

Friday, February 19
12:15-13:45

IMPROVING OUTCOME IN PULMONARY ARTERIAL HYPERTENSION

Chairpersons: **O Distler (CH),
M Matucci-Cerinic (I)**

12:15 Introduction
M Matucci-Cerinic (I)

12:20 Improving screening in PAH – Personal
experience with the DETECT algorithm
D Khanna (USA)

12:40 Improving trial design in PAH –
Results from recent trials
C Denton (UK)

13:00 Improving PAH management –
Addressing the three pathways
M Humbert (F)

13:20 Improving quality of life –
Are we addressing patients' needs?
U Müller-Ladner (D)

13:40 Panel discussion

GLAXOSMITHKLINE SATELLITE SYMPOSIUM

AUDITORIUM I

Friday, February 19

14:45-15:25

NEW AMBITIONS IN PAH-SSC

New EU Guidelines and their relevance
to SSC-PAH

C Denton (UK)

The AMBITION trial: The PAH-SSc results

J Langley (UK)

PATIENT PROGRAMME



THURSDAY, FEBRUARY 18
FRIDAY, FEBRUARY 19

THURSDAY, FEBRUARY 18

- 15:00-17:00 **Round-table Networking Meeting for Leaders of Patient Associations** ROOM 3B
Theme: "Patient Participation"
- 18:00-21:30 **Opening Lectures and Welcome Reception for clinicians and patients**

FRIDAY, FEBRUARY 19

- 09:00-09:10 **FESCA welcome:** ROOM 3C
A Kennedy (IRL)
- 09:10-09:30 **What Do we Know about Scleroderma Now?** ROOM 3C
Prof. C Denton (UK)
- 09:30-10:30 **What will Help my Digestive Problems?** ROOM 3C
Chairpersons: A Kennedy (IRL), C Denton (UK)
- Understanding the GI tract
Prof. J Clarke (USA)
- Nutrition in systemic sclerosis
A Cardoso (P)
- Learning to Cope with Gut Problems
A Vegh (H)
- My Journey
I Galetti (I)
- 09:30-10:00 **Parallel Session** ROOM 3B
Chairperson: J Welling (NL)
- New systemic sclerosis Classification and Management Recommendations
Prof. F Van den Hoogen (NL)

*SIMULTANEOUS TRANSLATION OFFERED IN room 3C
PATIENT POSTER DISPLAY AREA
FILM BY CHRISTY McCAFFREY (twice shown in room 3A)*

10:00-10:30 **Parallel Session** **ROOM 3B**

Chairperson: K Figelstone (UK)

ScleroID – a New Patient-Reported Outcome Measure

Dr. R Dobrota (CH), Dr. M Becker (D)

Is it Safe to get Pregnant?

Prof. V Steen (USA)

My New Baby

C Leite (P)

10:30 -11:00 **Coffee Break**

Developing Sexual Confidence

G Verzi (I)

11:00-12:00 **What will Help me Breathe Easily?
Is my Heart Involved?** **ROOM 3C**

**Chairpersons: A Portales (E),
Dr. A Herrick (UK)**

Understanding lung problems

Prof. O Distler (CH)

PAH and the Heart

Dr. A Cordeiro (P), Dr. M J Loureiro (P)

Struggles with Breathing

A Roennow (DK)

Enjoying your Relationship

R Kanters (NL)

12:00-13:00 **Parallel Session** **ROOM 3B**

**For Men with systemic sclerosis and Husbands
of those with systemic sclerosis**

Chairperson: J Welling (NL)

What will Help Men cope with systemic sclerosis?

Prof. S Santos (P), J Welling (NL)

Panel Discussion in English and Portuguese

11:00-12:00 **Parallel Session** **ROOM 3B**

EU projects with FESCA as partner

Chairperson: B Garay-Toth (H)

DeSScipher

Prof. U Müller-Ladner (D)

The Value of Patient Participation

Prof. Y Allanore (F)

13:00-14:00 **Lunch**

14:00-14:40 **What will Cure the Pain of Digital Ulcers &
Calcinosis?** **ROOM 3C**

**Chairpersons: D Charalambous (CY),
E Mateus (P)**

Our Recommendations for Treatment of Ulcers

Prof. M Matucci-Cerinic (I)

12:00-13:00 **Can I improve my sexual relations, or get
pregnant safely?** **ROOM 3C**

**Chairpersons: A Kennedy (IRL),
T Ngcozana (UK)**

Improving Sexuality

Prof. A Tincani (I)

How we Care for Ulcers in a Portuguese Clinic

Prof. J Delgado Alves (P)

Pain: The Greatest Struggle for Many Patients

Y Courcoux (F)

14:40-15:15 **How do I Cope with my Facial Changes?**
ROOM 3C

**Chairpersons: B Garay-Toth (H),
Prof. P Carreira (E)**

Changing Faces and Self-Esteem
Prof. A Tyndall (CH)

Readjusting my Life
M Sauvé (CND)

My Story
S Sandulescu (ROM)

14:00-15:00 **Parallel Session - Panel Discussion**
Juvenile Scleroderma ROOM 3B
Chairpersons: K Fligelstone (UK)

Moving On from systemic sclerosis
**Dr. I Foeldvari (D), G Verzi (I),
A. Alferes Pereira (P)**

15:15-16:30 **How Can I Manage Systemic
Sclerosis Myself?** ROOM 3C
**Chairpersons: N Paciotti (CH),
Dr. M J Salvador (P)**

Coping with the Everyday Challenges
of Scleroderma
Dr. L Kwakkenbos (NL)

Do Support Groups Help?
V Delisle (CAN)

Painful Symptoms that Cannot be Measured
Dr. J Lee (CND)

Mind & Body Strength
Dr. L A Saketkoo (USA)

15:00-15:30 **Parallel Session** ROOM 3B
**Chairpersons: H Gaspar (P),
A Portales (E)**

Caring for your Teeth in systemic sclerosis
Dr. A Pequeno
(in Portuguese)

15:30-16:30 **Parallel Session** ROOM 3B
Scleroquizz Game
Nurse A Noullez (F), Nurse G Wojtasik (F)
(in English and French)

09:00-15:00 **Parallel Session** ROOM 3A
Interactive Workshops. Exercises to Improve Breathing
and Facial Flexibility
Therapists: **J Brozd PT (CR), V Mišura PT (CR)
and S Roskar (CR)**

09:30-10:10 Breathing Exercises

10:15-10:45 Face Exercises

11:00-11:45 Face Exercises

12:00-13:00 Breathing Exercises

14:00-15:00 "Ask a Physiotherapist" – demonstration of
exercises in response to questions.

SATURDAY, FEBRUARY 20

09:00-10:00 **Meet the Professor: Answers to your questions in your own language in English -**
 (translation into Portuguese, French, Spanish)
Chairperson: A Portales (E) ROOM 3C
Speakers: Prof. M Mayes (USA) & Prof. P Carreira (E)

in German ROOM 3A
Chairperson: G Niehaus (D)
Speaker: Prof. U Müller-Ladner (D)

in Italian ROOM 3B
Chairperson: G Tassini (I)
Speaker: Prof. M Matucci-Cerinic (I)

10:00-11:00 **What is Research doing for Me? What New Therapies can I try? ROOM 3C**
Chairperson: J Welling (NL), Prof. A Tyndall (CH)

The Hope of Systemic Drugs
Prof. C Denton (UK)

Considering Stem-Cell Transplants
Prof. J Van Laar (NL)

My Lung Transplant
A Martin (CH)

My Stem-Cell Transplant
R Kanters (NL)

11:00-11:30 **Coffee Break**

11:30-12:00 **After 10 years with systemic sclerosis, What Can I Expect? ROOM 3C**
Chairpersons: A Roennow (DK), Dr. P Coelho (P)

Predicting the Future with systemic sclerosis
Dr. J Lee (CND)

A Long Life With Systemic Sclerosis
K Fligelstone (UK)

12:00-13:00 **Coping: How can my family and I manage systemic sclerosis better? ROOM 3C**
Chairpersons: A Kennedy (IRL), Dr. C Resende (P)

Dealing with Chronic Fatigue
Dr. J Poole (USA)

Breathing Exercises
Dr. J Poole (USA)

How to share systemic sclerosis with a loved one
H and E Lever (S)

Finding your way as a single mother
M Gaafar (CH)

A Meditation for stress relief
Dr. L A Saketkoo (USA)

10:30-11:30 **Parallel Session ROOM 3B**
 Wax Bath demonstrations
Dr. W Gregory PT (UK)

11:30-12:30 **Parallel Session ROOM 3B**
 Hand exercises
Dr. W Gregory PT (UK)

PATIENT PROGRAMME

SATURDAY, FEBRUARY 20

10:00-11:00 and 11:00-12:00

Parallel Sessions

ROOM 3A

Screening of film "Beneath the Surface"

Christy McCaffrey (USA)

12:00-12:30 **Parallel Session**

ROOM 3A

Chairperson: H Gaspar (P)

Nutrition in systemic sclerosis

A Cardoso (P) (in Portuguese)

13:00 **Closure of Congress**

13:30-15:30 **Fesca Meeting of all Representatives**

ROOM 3B

POSTER SESSION



PATHOGENESIS

- P.001** **CAVEOLIN 1 GENE VARIANTS MAY EFFECT DISEASE PROGRESSION IN SYSTEMIC SCLEROSIS RELATED INTERSTITIAL LUNG DISEASE**
S. Yavuz, E. Lopez Isac, A.M. Onat, N. Yilmaz, L. Kilic, A. Akdogan, J. Martin
- P.002** **ALTERATIONS IN MIRNA CONTENT OF EXOSOMES ISOLATED FROM SERUM OF SYSTEMIC SCLEROSIS PATIENTS: A POTENTIAL MECHANISM FOR THE INITIATION AND PROGRESSION OF A PROFIBROTIC PHENOTYPE**
P. Wermuth, S. Piera-Velazquez, S. Jimenez
- P.003** **DETECTION OF POTENTIAL SUSCEPTIBILITY FACTORS IN PATIENTS WITH SYSTEMIC SCLEROSIS IN POPULATION OF SERBIA**
M. Vreca, V. Spasovski, M. Andjerkovic, M. Stojiljkovic, N. Tosic, A. Zekovic, N. Damjanov, S. Pavlovic
- P.004** **IDENTIFICATION OF NOVEL DRIVERS OF FIBROSIS IN SSC**
J. Verneau , D. Abraham, T. Johnson, J. Norman, M.Ponticos
- P.005** **EXTRACELLULAR HEAT SHOCK PROTEIN 90 IS ASSOCIATED WITH DISEASE ACTIVITY, LUNG INVOLVEMENT AND SKIN FIBROSIS IN SYSTEMIC SCLEROSIS**
H. Storkanova, H. Hulejova, M. Spiritovic, R. Becvar, K. Pavelka, J. Vencovsky, J. Distler, L. Senolt, M. Tomcik
- P.006** **INTERLEUKIN-35 IS OVEREXPRESSED IN SYSTEMIC SCLEROSIS AND ITS ELEVATED SERUM LEVELS ARE ASSOCIATED WITH EARLY DISEASE**
M. Tomcik, P. Zerr, K. Palumbo-Zerr, H. Storkanova, H. Hulejova, M. Spiritovic, O. Kodet, J. Stork, R. Becvar, J. Vencovsky, K. Pavelka, M. Filkova, J. Distler, L. Senolt
- P.007** **ASSOCIATION STUDY OF A GLUTAMATE CYSTEIN LIGASE GENE POLYMORPHISM WITH SUSCEPTIBILITY TO SYSTEMIC SCLEROSIS**
A. Tochimoto, Y. Kawaguchi, M. Kawamoto, K. Takagi, T. Higuchi, Y. Ichimura, H. Yamanaka
- P.008** **EXPOSURE TO QUARTZ DUST AND THE RISK OF DEVELOPMENT OF CONNECTIVE TISSUE DISEASES**
C. Beer, V. Schlünssen, D. Sherson, A. Trolldborg, B.D. Nielsen, A.B. Olesen, G. Jacobsen, K. Søndergaard, H.A. Kolstad
- P.009** **ANTI-VINCULIN ANTIBODIES: POTENTIAL VASCULAR MARKERS IN SYSTEMIC SCLEROSIS PATIENTS**
Y. Suliman, S. Kafaja, M. Alemam, I. Valera, N. Jackson, E. Marsh, W. Morales, R. Singh, P. Clements, M. Pimentel, D. E. Furst
- P.010** **ENDOTHELIN-1 INDUCES HUMAN MONOCYTE POLARIZATION INTO ALTERNATIVELY ACTIVATED MACROPHAGES**
S. Soldano, P. Montagna, A.C. Trombetta, R. Brizzolaro, A. Sulli, C. Pizzorni, S. Paolino, M. Cutolo
- P.011** **A RARE COEXISTENCE OF ANTI-CENTROMERE ANTIBODIES WITH ANTI-RNA POLYMERASE III & ANTI-TOPOISOMERASE-I ANTIBODIES**
K. Solanki, A. Schollum
- P.012** **IMMUNOLOGICAL REVIEWS DURING SYSTEMIC SCLERODERMA**
D. Si Ahmed, M. Bouali - Benhalima, F. Haddoum, L. Boudjella, F. Bouali
- P.013** **NOTCH SIGNALING IN THE ENDOTHELIAL DYSFUNCTION OF SYSTEMIC SCLEROSIS**
F. Seguro Paula, M.C. Amaral, J. Delgado Alves
- P.014** **LYSOPHOSPHATIDIC ACID IS ELEVATED IN THE PLASMA OF PATIENTS WITH SCLERODERMA**
S. Schoenfeld, E. Berdyshev, I. Bronova, V. Pace, A. Tager, F. Castelino

- P.015 ENVIRONMENTAL FACTORS IN SYSTEMIC SCLEROSIS: A CASE-CONTROL STUDY**
P. Sampaio-Barros, L. A. Aguila, A. C. Medeiros, H. C. Silva, L. P. C. Seguro, D. C. O. Andrade
- P.016 THE GLOBAL MICRORNA PROFILE OF SYSTEMIC SCLEROSIS WHOLE SKIN/DERMAL FIBROBLASTS AND THE ROLE OF THE XQ26.3 MIRNA CLUSTER AS A TGF-B PATHWAY POSITIVE FEEDBACK MECHANISM**
G. Salazar, J. Hagan, M. Wu, X. Guo, X. Zhuo, J. Charles, O. Distler, E. Pachera, M. Mayes, S. Assassi
- P.017 IL-10-PRODUCING REGULATORY B CELLS ARE DECREASED AND NEGATIVELY ASSOCIATED WITH AUTOANTIBODY TITRES IN SYSTEMIC SCLEROSIS**
L. Sakkas, A. Mavropoulos, C. Liaskos, T. Simopoulou, W. Meyer, A. Varna, C. Katsiari, D. Bogdanos
- P.018 EVALUATION OF FAT TISSUE AND PERITONEAL CIRCUMFERENCE, USING TRANSABDOMINAL SONOGRAPHY AND THEIR CORRELATION WITH DISEASE ACTIVITY AND INFLAMMATION IN SYSTEMIC SCLEROSIS PATIENTS**
C. Rotondo, A. Chialà, M. Nivuori, M.G. Anelli, E. Praino, L. Coladonato, C. Fiorentini, G. Laselva, G. Lapadula, F. Iannone
- P.019 EVALUATION OF SOLUBLE HLA-G IN SYSTEMIC SCLEROSIS**
P. Contini, M. Borro, S. Negrini, G. Murdaca, F. Puppo
- P.020 ANTIFIBROTIC EFFECTS OF THE TYROSINE KINASE INHIBITOR, BOSUTINIB, ON CULTURED NORMAL AND SYSTEMIC SCLEROSIS DERMAL FIBROBLASTS**
S. Piera-Velazquez, F.A. Mendoza, K. Fasino, S.A. Jimenez
- P.021 A LONGITUDINAL PILOT STUDY TO INVESTIGATE THE ROLE OF SELENIUM DEFICIENCY IN THE PATHOGENESIS OF SYSTEMIC SCLEROSIS**
X. Pan, A. Marsden, J. Wikinson, P. New, J. Manning, R. Unwin, G. Cooper, A. Herrick
- P.022 TGFB DRIVEN EXPRESSION OF LONG NONCODING RNA H19X AS A KEY FACTOR IN SYSTEMIC SCLEROSIS AND OTHER FIBROTIC DISEASES**
E. Pachera, S. Assassi, G. Salazar, M. Frank-Bertoncelj, R. Dobrota, M. Brock, C. Hellerbrand, C. Feghali-Bostwick, J.H. Distler, G. Kania, O. Distler
- P.023 AMELIORATION OF SCLERODERMATOUS GRAFT VERSUS HOST DISEASE IN MICE BY BLOCKING STAT3 AND WNT/ BETA-CATENIN PATHWAYS**
F. Morin, N. Kavian, C. Nicco, C. Chereau, F. Batteux
- P.024 SERUM CONCENTRATIONS OF 25-OH VITAMIN D IN A COHORT OF PATIENTS WITH SYSTEMIC SCLEROSIS – A CROSS-SECTIONAL CLINICAL STUDY**
T. Meirinhos, R. Fonseca, D. Gonçalves, F. Aguiar, T. Martins-rocha, L. Costa
- P.025 PATHOGENIC OR CASUAL ASSOCIATION BETWEEN SYSTEMIC SCLEROSIS AND FABRY DISEASE**
C. Pintaudi, R. Cimino, S. Mazzuca
- P.026 ASSOCIATION OF OCCUPATIONAL EXPOSURE WITH FEATURES OF SYSTEMIC SCLEROSIS**
I. Marie
- P.027 THE HOMEOPROTEIN TRANSCRIPTION FACTOR ENGRAILED-1 REGULATES CANONICAL TGFβ SIGNALING IN SYSTEMIC SCLEROSIS**
T. Mallano, K. Palumbo-Zerr, Ch. Beyer, C. Dees, J. Huang, Th. Wohlfahrt, G. Schett, J. Distler
- P.028 INCREASED CD27 EXPRESSION IN THE SKIN AND SERA OF THE PATIENTS WITH SYSTEMIC SCLEROSIS**
T. Makino, M. Jinnin, M. Nakayama, S. Fukushima, S. Masuguchi, H. Ihn
- P.029 PREMATURE TELOMERE SHORTENING OF PERIPHERAL BLOOD LYMPHOCYTES IN SYSTEMIC SCLEROSIS**
E. Lee, J.A. Park, H.M. Kwon, J. Lee, C.M. Weyand, J.J. Goronzy, H. Fujii
- P.030 B CELLS SUBSETS AND CYTOKINES PRODUCTION IN SYSTEMIC SCLEROSIS**
A. Forestier, T. Guerrier, S. Dubucquoi, G. Lefèvre, I. Yakoub-Agha, C. Hauspie, M. Jendoubi, P.Y. Hatron, E. Hachulla, M. Labalette, D. Launay
- P.031 SIRT-1 REGULATES TGF-β INDUCED DERMAL FIBROBLAST MIGRATION VIA MODULATION OF CYR61 EXPRESSION**
H. Seo, E. Kwon, M. Cho, S. Lee, J. Kim
- P.032 PAN PPAR AGONIST IVA337 HAS AN ANTI-FIBROTIC EFFECT IN MULTIPLE IN VITRO AND IN VIVO FIBROSIS MODELS**
E. Defrene, C. Estivalet, I. Jantzen, J. Tessier, E. Vasseur, J.M. Germain, F. Kupkowski, C. Robert, P. Faye, P. Tuyaa Boustugue, A. Philippot, V. Virely, X. Gawronski, G. Wettstein, C. Fromond, P. Broqua, J.L. Junien, J.M. Luccarini, I. Konstantinova
- P.033 OCTREOTIDE AMELIORATES DERMAL FIBROSIS IN BLEOMYCIN-INDUCED SCLERODERMA**
S. Koca, S. Orhan, S. Yolbas, A. Yildirim, A. Tektemur, I. H. Ozercan, E. Onalan
- P.034 ACTIVATION OF THE TRANSIENT RECEPTOR POTENTIAL MELASTATINE 8 (TRPM8) RESULTS IN THE UPREGULATION OF FIBROTIC GENES EXPRESSION: POTENTIAL PATHWAY TO FIBROSIS IN SSC**
B. Kahaleh, Y. Wang

- P.035** **INCREASED LEVELS OF LARGELY HYPOMETHYLATED CIRCULATING DNA IN SYSTEMIC SCLEROSIS: A POTENTIAL DISEASE BIOMARKER**
B. Kahaleh, N. Altorok, S. Nada, A. Al Harbi, Y. Wang
- P.036** **ENHANCED PROLIFERATION AND APOPTOSIS RESISTANCE OF SCLERODERMA DERMAL VASCULAR SMOOTH MUSCLE CELLS**
B. Kahaleh, N. Altorok, S. Nada, A. Alharbi, Y. Wang
- P.037** **IL-9 OVER-EXPRESSION AND TH9 POLARIZATION CHARACTERIZE SSC PATIENTS**
G. Guggino, F. Ciccia, P. Cipriani, A. Rizzo, P. Di Benedetto, P. Ruscitti, V. Liakouli, A. Alessandro, G. Sireci, G. Triolo
- P.038** **ENERGY METABOLISM IN SKIN FIBROBLASTS FROM SCLERODERMA PATIENTS**
I. Gomes Cantanhede, X. Shi-Wen, K. Khan, J.S. Owen, J.L. Lima-Filho, D. Brunaska, D.J. Abraham, JW Taanman
- P.039** **AUTOPHAGOSOMES ARE ESSENTIAL FOR THE SECRETION OF TGF-BETA**
B. Eckes, J. Nüchel, A. Zuk, K. Schönborn, G. Sengle, M. Plomann, T. Krieg
- P.040** **PERIPHERAL B LYMPHOCYTES SECRETE BOTH INTERLEUKIN 6 AND TRANSFORMING GROWTH FACTOR-BETA AND POTENTIATE FIBROBLASTS ACTIVATION IN SYSTEMIC SCLEROSIS**
N. Dumoitier, A. Regent, S. Lofek, B. Chaigne, B. Terrier, J. London, A. Berezne, V. Witko-Sarsat, N. Varin-Blank, L. Mouthon
- P.041** **NKX2-5: A NOVEL LOCUS GENETICALLY ASSOCIATED WITH SCLERODERMA**
A. Dritsoula, C. Fonseca, J. Martin, A. Herrick, C. Denton, M. Ponticos
- P.042** **PATHOGENETIC OVERLAP BETWEEN LOCALISED AND SYSTEMIC SCLERODERMA: A STUDY OF NODULAR MORPHOEIA IN SYSTEMIC SCLEROSIS**
E. Derrett-Smith, N. Gak, S. Nihtyanova, V. Ong, V. Swale, C. Orteu, C. Denton
- P.043** **ORGAN INVOLVEMENT IN PATIENTS WITH SYSTEMIC SCLEROSIS IS PREDICTED BY NAILFOLD VIDEOCAPILLAROSCOPY PATTERNS INDEPENDENT OF DISEASE-SPECIFIC AUTOANTIBODIES**
I.M. Markusse, J. Meijs, B. de Boer, J.A. Bakker, H.P.C. Schippers, A.A. Schouffoer, N. Ajmone Marsan, L.J.M. Kroft, M.K. Ninanber, T.W.J. Huizinga, J.K. de Vries-Bouwstra
- P.044** **EPIGENETIC REGULATION OF IL-6R BY MICRORNA-34A AND MICRORNA-155 IN SYSTEMIC SCLEROSIS**
S. Alivernini, S. Bosello, B. Tolusso, S. Canestri, L. Bui, M. Fabrizi, G. Massi, I. McInnes, M. Kurowska-Stolarska, G. Ferraccioli
- P.045** **CHARACTERIZATION OF INFLAMMATORY CELL INFILTRATE OF SCLERODERMA SKIN: THE ROLE OF B CELLS IN SKIN PROGRESSION**
S. Bosello, S. Alivernini, G. Lama, G. De Luca, G. Sica, G.F. Ferraccioli
- P.046** **IMMUNOPHENOTYPE CHARACTERIZATION OF SYSTEMIC SCLEROSIS PATIENTS: ASSOCIATED CLINICAL FEATURES AND PROGNOSTIC IMPLICATIONS**
I. Cordeiro, A. Duarte, S. Sousa, L. Teixeira, J. Canas Da Silva, A. Cordeiro, M.J. Santos
- P.047** **LIPID PEROXIDATION, ANTIOXIDANT SYSTEM AND IMMUNOLOGICAL STATUS FROM THE CHILDREN WITH SYSTEMIC SCLEROSIS**
I. Chyझेuskaya, L. Belyaeva, L. Zajtseva, T. Yuraga, H. Hrustaleva, A. Lyatun
- P.048** **CHARACTERISTICS OF SYSTEMIC SCLEROSIS AND LIMITED SCLERODERMA IN CHILDREN**
I. Chyझेuskaya, L. Belyaeva, L. Zajtseva, T. Yuraga, H. Hrustaleva, A. Lyatun
- P.049** **EVIDENCE FOR A DERANGEMENT OF THE MICROVASCULAR SYSTEM IN PATIENTS WITH A VERY EARLY DIAGNOSIS OF SYSTEMIC SCLEROSIS**
I. Chora, E. Romano, C. Mazzotta, M. Manetti, R. Costa, V. Machado, A. Cortez, S. Guiducci, R. Soares, M. Matucci-Cerinic
- P.050** **CHEMERIN: A NOVEL MARKER OF EARLY AND SYSTEMIC SCLEROSIS?**
C. Chighizola, E. Raschi, T. Schioppo, C. Artusi, F. Ingegnoli, M.O. Borghi, P.L. Meroni
- P.051** **VISFATIN, ADIPONECTIN, LEPTIN AND IL-17 SERUM LEVELS IN PATIENTS WITH PERICARDIAL EFFUSION RELATED TO SYSTEMIC SCLEROSIS**
A. Chialà, C. Rotondo, M.G. Anelli, E. Praino, M. Giannini, N. Lacarpia, R. Bizzoca, D. Natuzzi, G. Lapadula, F. Iannone
- P.052** **ANALYSIS OF RARE PROTEIN AND RNA COMPONENTS IMMUNOPRECIPITATED BY SERA FROM SYSTEMIC SCLEROSIS PATIENTS**
A. Ceribelli, N. Isailovic, M. De Santis, E. Generali, M. Massarotti, M. Satoh, C. Selmi
- P.053** **ARE ANTINUCLEOSOME ANTIBODIES BIOMARKERS OF MICROANGIOPATHY IN SYSTEMIC SCLEROSIS PATIENTS?**
E. Rezus, A. Cardoneanu, L.A. Macovei, C. Banu, A. Burlui
- P.054** **OCCUPATIONAL EXPOSURE TO ORGANIC SOLVENTS, EPOXY RESINS AND SILICA DUST IN SYSTEMIC SCLEROSIS PATIENTS: DATA FROM TWO ROMANIAN CENTERS**
E. Rezus, A. Burlui, A. Cardoneanu, I.G. Stamate, M. Parvu

- P.055 ASSOCIATION OF ANTI-PM/SCL ANTIBODY WITH RISK OF MALIGNANCY IN SCLERODERMA**
C. Bruni, A. Lages, H. Patel, J. Harvey, V. Ong, M. Matucci-Cerinic, E. Derrett-Smith, C.P. Denton
- P.056 TREATMENT WITH ABATACEPT PREVENTS EXPERIMENTAL DERMAL FIBROSIS AND INDUCES REGRESSION OF ESTABLISHED INFLAMMATION-DRIVEN FIBROSIS**
M. Ponsoye, C. Frantz, N. Ruzehaji, M. Elhai, B. Ruiz, A. Cauvet, Y. Allanore, J. Avouac
- P.057 CHARACTERIZATION OF MICRO AND NANOPARTICLES AND QUANTIFICATION OF TRACE ELEMENTS IN SERUM AND HAIR SAMPLES OF SYSTEMIC SCLEROSIS PATIENTS**
E. Artoni, G.L. Sighinolfi, M. Colaci, D. Giuggioli, C. Ferri
- P.058 AN UNUSUAL PRESENTATION OF CALCIFICATIONS IN LIMITED CUTANEOUS SYSTEMIC SCLEROSIS**
J. Schollum, D. H. N. White, K. K. Solanki

PULMONARY INCLUDING INTERSTITIAL LUNG DISEASE AND PULMONARY ARTERIAL HYPERTENSION

- P.059 RED BLOOD CELL DISTRIBUTION WIDTH AS A USEFUL INDICATOR TO PREDICT PULMONARY ARTERIAL HYPERTENSION IN PATIENTS WITH SYSTEMIC SCLEROSIS**
J. Zhao, H.N. Mo, Q. Wang, D. Xu, M.T. Li, X.F. Zeng
- P.060 REVERSIBILITY OF PULMONARY ARTERIAL HYPERTENSION, ASSOCIATED WITH SYSTEMIC SCLEROSIS: CAN IT REALLY BE TRUE?**
A. Volkov, E. Nikolaeva, I. Kurmukov, N. Yudkina
- P.061 PULMONARY AND ACTIVATION REGULATED CHEMOKINE IS ASSOCIATED WITH EXTENT OF INTERSTITIAL LUNG DISEASE IN SYSTEMIC SCLEROSIS**
E. Volkmann, D. Tashkin, R. Elashoff, C.H. Tseng, P. Clements, M. Roth, D. Furst, D. Khanna, J. Charles, M. Mayes, S. Assassi
- P.062 CXCL4: A POTENTIAL BIOMARKER FOR SYSTEMIC SCLEROSIS-RELATED INTERSTITIAL LUNG DISEASE**
E. Volkmann, D. Tashkin, R. Elashoff, C.H. Tseng, P. Clements, M. Roth, D. Furst, D. Khanna, J. Charles, M. Mayes, S. Assassi
- P.063 INVESTIGATING MECHANISMS OF GENDER BIAS IN LUNG FIBROSIS USING MICE WITH SEX CHROMOSOME COMPLEMENT**
I. Valera, S. Kafaja, B. Pham, R.R. Singh
- P.064 ASSOCIATION OF THE HYPOXIA-INDUCIBLE FACTOR 1A (HIF1ALPHA) GENE POLYMORPHISM IN JAPANESE SYSTEMIC SCLEROSIS (SSC) WITH THE PULMONARY ARTERIAL HYPERTENSION (PAH)**
K. Takagi, Y. Kawaguchi, M. Kawamoto, T. Higuchi, Y. Ichimura, H. Yamanaka
- P.065 TROPISETRON ATTENUATES EXPERIMENTALLY INDUCED LUNG FIBROSIS AND FURTHER HIGHLIGHTS A POTENTIAL NEW TREATMENT STRATEGY AGAINST SCLERODERMA BY TARGETING ALPHA7 NICOTINIC ACETYLCHOLINE RECEPTORS**
A. Stegemann, C. Albrecht, T.A. Luger, M. Böhm
- P.066 INTERSTITIAL LUNG DISEASE IN SCLERODERMA PORTUGUESE PATIENTS**
S. Sousa, A. Duarte, I. Cordeiro, L. Teixeira, J. Canas da Silva, A. Cordeiro, M.J. Santos
- P.067 DEFINING NOVEL FIBROBLAST SIGNALLING PATHWAYS IN PULMONARY FIBROSIS**
X. Shiwen, E.A. Renzoni, M. Ponticos, C.P. Denton, A.U. Wells, D.J. Abraham
- P.068 PROFILE AND PROGNOSIS OF PULMONARY ARTERIAL HYPERTENSION ASSOCIATED WITH CONNECTIVE TISSUE DISEASES**
P. Sampaio-Barros, A. P. L. Assad, L. Alves jr, L. P. C. Seguro, R. C. Tonon, F. Gavillanes, C. Jardim, C. J. C. S. Fernandes, L. T. K. Morinaga, S. Hoette, R. Souza
- P.069 RECURRING SPONTANEOUS PNEUMOTHORAX IN PATIENT WITH SYSTEMIC SCLEROSIS**
M. Salgado, J. Vaz, L. Theilacker, F. Freire, S. Francisco, D. Sugui, R. Pereira Júnior, F. Bandeira, S. Hora
- P.070 SCL-70 AUTOANTIBODY DETERMINED BY IMMUNODIFFUSION IS A CLINICAL PREDICTOR OF FASTER INTERSTITIAL LUNG DISEASE PROGRESSION IN SYSTEMIC SCLEROSIS**
G. Salazar, M. Fritzier, M. Hudson, C. Mejia Otero, R. Estrada-y-Martin, D. Nair, C. Pedroza, M. Mayes, S. Assassi

- P.071 INTERNATIONAL CLASSIFICATION OF FUNCTIONING, DISABILITY, AND HEALTH (ICF) CORE SETS FOR CTD-ILD AND IDIOPATHIC PULMONARY FIBROSIS (IPF) – A NECESSARY MAP IN THE ERA OF ICD-11**
L. Saketkoo, R. Escorpizo, K.J. Keen, K. Fligelstone, D.R. Lesage, C. Sarver, A.M. Russel, J.A. Lasky, M.R. Lammi, J. Varga, O. Distler
- P.072 MYCOPHENOLATE USE IN SYSTEMIC SCLEROSIS (SSC) PATIENTS WITH A DESIGNATION OF ‘PULMONARY HYPERTENSION (PH)’ : FORCED VITAL CAPACITY (FVC), OUTCOMES AND SURVIVAL FROM THE EUSTAR DATAABASE**
L. Saketkoo, D. Huscher, C. Denton, G. Riemekasten, V. Steen, O. Distler
- P.073 INTERSTITIAL LUNG DISEASE IN SYSTEMIC SCLEROSIS - A DESCRIPTIVE STUDY**
D. Rosa-Gonçalves, R. Fonseca, F. Aguiar, T. Martins-Rocha, M. Bernardes, L. Costa
- P.074 ESOPHAGEAL DILATATION AND INTERSTITIAL LUNG DISEASE IN SYSTEMIC SCLEROSIS: A CROSS-SECTIONAL STUDY**
C. Richardson, R. Agrawal, J. Lee, O. Almagor, R. Nelson, J. Varga, M. Cuttica, J. D'Amico Dematte, R. Chang, M. Hinchcliff
- P.075 IMPACT OF IMPAIRED RESPIRATORY MUSCLE STRENGTH ON DYSPNEA AND EXERCISE INTOLERANCE IN SYSTEMIC SCLEROSIS PATIENTS**
M.S. García-Pacheco, J.L. Callejas-Rubio, R. Ríos-Fernández, A.R. González-Ramírez, M.R. Cabello-Salas, N. Ortego-Centeno
- P.076 CHEST HIGH-RESOLUTION COMPUTED TOMOGRAPHY FINDINGS IN PATIENTS WITH SYSTEMIC SCLEROSIS**
A. Raposo, I. Gonçalves, J. Sousa Neves, M. Cerqueira, D. Santos Faria, F. Teixeira, D. Peixoto, J. Costa, S. Alcino, C. Afonso
- P.077 UPREGULATION OF SERUM SCCA-IGM IN SCLERODERMA PATIENTS WITH REDUCED DLCO: A NEW BIOMARKER OF PULMONARY INVOLVEMENT?**
E. Zanatta, A. Martini, A. Biasiolo, E. Pigatto, P. Polito, K. Bourij, M. Favaro, L. Punzi, P. Pontisso, F. Cozzi
- P.078 THE PROGNOSIS INTERVALS FOR PTS WITH SSC-ILD USING DISCRIMINANT ANALYSIS**
O. Ovsyannikova, S. Glukhova, O. Koneva, V. Lesnyak, L. Ananieva
- P.079 ASSESSMENT OF PULMONARY FUNCTION IN PATIENTS DIAGNOSED OF EARLY SYSTEMIC SCLEROSIS**
F. Ortiz Sanjuán, C. Alcañiz Escandell, K. Aievalo Ruales, I. Chalmeta Verdejo, C. Fedec Olmos, J. Frago Gil, L. González Puig, E. Labrador Sánchez, I. Martínez Cordellat, R. Negueroles Albuixech, J. L. Valero Sanz, E. Grau García, J. Ivorra Cortés, C. Núñez-Cornejo Piquer, J. A. Román Ivorra
- P.080 PULMONARY FIBROSIS IN PATIENTS WITH SYSTEMIC SCLEROSIS AND THE ASSOCIATION WITH IMMUNOGLOBULIN A**
K. Gunnarsson, S. Nyrén, E. Svenungsson, A. Nordin
- P.081 MODELLING OF LONGITUDINAL CHANGES IN LUNG FUNCTION IN PATIENTS WITH SYSTEMIC SCLEROSIS AND THEIR ASSOCIATION WITH DEVELOPMENT OF PULMONARY HYPERTENSION**
S. Nihtyanova, V. Ong, C. Denton
- P.082 COMBINED PULMONARY FIBROSIS AND EMPHYSEMA (CPFE) IN SYSTEMIC SCLEROSIS: A SYNDROME ASSOCIATED WITH HEAVY MORBIDITY AND MORTALITY**
N. Champiaux, V. Cottin, M.P. Revel, D. Valeyre, H. Nunes, E. Hachulla, D. Launay, B. Crestani, C. Cazalets, P. Jegou, G. Bussone, A. Berezné, L. Guillevin, J.F. Cordier, L. Mouthon
- P.083 SURVIVAL IN SCLERODERMA PULMONARY ARTERIAL HYPERTENSION IN THE MODERN TREATMENT ERA: RESULTS FROM A LARGE MULTICENTRE AUSTRALIAN COHORT STUDY**
K. Morrisroe, M. Huq, C. Rabusa, J. Sahhar, J. Zochling, J. Roddy, S. Proudman, M. Stevens, M. Nikpour
- P.084 RISK FACTORS FOR DEVELOPMENT OF PULMONARY ARTERIAL HYPERTENSION IN AUSTRALIAN SCLERODERMA PATIENTS: RESULTS FROM A LARGE MULTICENTRE COHORT STUDY**
K. Morrisroe, M. Huq, C. Rabusa, J. Sahhar, J. Zochling, J. Roddy, G. Strickland, V. Thakkar, S. Proudman, W. Stevens, M. Nikpour
- P.085 SYSTEMIC SCLEROSIS (SSC) AND INTERSTITIAL LUNG DISEASE (ILD): PREDICTORS OF PROGRESSION OF ILD IN PATIENTS WITH SSC**
A. Morais Castro, C. Resende, L. Ferreira, D. Moniz, C. Ponte, A. Pereira Da Silva
- P.086 PATIENTS WITH SYSTEMIC SCLEROSIS AND PULMONARY INVOLVEMENT - CASES REVIEW**
S. Martins, A. Sanches, R. Assis, R. Escoli, J. Garcia, M. Carvalho, F. Pimenta
- P.087 DIAGNOSIS OF TRUE PULMONARY ARTERIAL HYPERTENSION IN SYSTEMIC SCLEROSIS REMAINS CHALLENGING: A SINGLE CENTRE EXPERIENCE**
M. Luknar, P. Lesny, A. Tuchynova, J. Rovensky, E. Goncalvesova
- P.088 MID-TERM EFFECTS OF RITUXIMAB IN CONNECTIVE TISSUE DISORDERS RELATED INTERSTITIAL LUNG DISEASE (ILD)**
G. Lepri, J. Avouac, P. Airolò, F. Anguita Santos, S. Bellando Randone, J. Blagojevic, F. Garcia Hernandez, J. A. Gonzalez Nieto, S. Guiducci, S. Jordan, L. Vidya, B. Maurer, A. Selva-O Callaghan, V. Ricciari, O. Distler, M. Matucci-Cerinic, Y. Allanore

- P.089** **SERUM CONCENTRATION OF SP-D IN PATIENTS WITH SYSTEMIC SCLEROSIS AS POTENTIAL INDEX OF PULMONARY INVOLVEMENT**
E.J. Kucharz, A. Grosicka
- P.090** **THE IMPORTANCE OF HIGH RESOLUTION COMPUTED TOMOGRAPHY (HRCT) IN ASSESSMENT OF RITUXIMAB EFFICACY IN PATIENTS WITH INTERSTITIAL LUNG DISEASE (ILD) ASSOCIATED WITH SYSTEMIC SCLEROSIS (SSC)**
O. Koneva, L. Ananieva, O. Desinova, N. Kovaleva, O. Ovsyannikova, M. Starovoytova, A. Volkov
- P.091** **SERO-CONVERSION FROM ANTI-TH/TO TO ANTI-CENTROMERE ANTIBODIES IN A PATIENT WITH SYSTEMIC SCLEROSIS AND SEVERE LUNG DISEASE**
M. Koenig, J.L. Senecal, G. Perez, T. Camacho, A. Seaman, C. Bentow, M.Mahler
- P.092** **COEXISTENCE OF SYSTEMIC SCLEROSIS AND SARCOIDOSIS: A CASE REPORT**
S. Kobak, F. Sever, O. Sivrikoz, A. Karaarslan
- P.093** **THE EFFECT OF GASTROESOPHAGEAL REFLUX ON THE LUNG FUNCTION AND RADIOLOGIC FINDING IN PATIENTS WITH SYSTEMIC SCLEROSIS RELATED INTERSTITIAL LUNG DISEASE**
H. Kim, J. Chae, H. Kim, S. Uh
- P.094** **THE ROLE OF LUNG ULTRASOUND FOR EVALUATION OF PULMONARY INVOLVEMENT (PULMOFIBROSIS) IN SYSTEMIC SCLEROSIS**
R. Karalilova, Y. Peeva, Z. Batalov, P. Selimov, S. Tsvetkova, A. Batalov
- P.095** **POTENTIAL BIOMARKERS FOR STRATIFICATION OF PULMONARY FIBROSIS IN SYSTEMIC SCLEROSIS**
P. Juhl, A.S. Siebuhr, N.U. Hansen, F. Genovese, M.A. Karsdal, D.J. Leeming, A.C. Bay-Jensen
- P.096** **EXHALED NITRIC OXIDE IN SYSTEMIC SCLEROSIS LUNG DISEASE**
N. K. Kozij, J. T. Granton, P. E. Silkoff, J. Thenganatt, S. Chakravorty, S. R. Johnson
- P.097** **IMPACT OF SOCIOECONOMIC STATUS ON SURVIVAL IN CONNECTIVE TISSUE DISEASE ASSOCIATED AND IDIOPATHIC PULMONARY ARTERIAL HYPERTENSION**
C. H. Jin, J. T. Granton, J. Thenganatt, J. Moric, A. Gupta, A. T. Kron, C. Chau, S. Johnson
- P.098** **MORTALITY IN SYSTEMIC SCLEROSIS ASSOCIATED PULMONARY ARTERIAL HYPERTENSION: SINGLE CENTER LONG-TERM EXPERIENCE WITH RISK ASSESSMENT ACCORDING TO THE NEW ESC/ERS GUIDELINES**
M. Inanc, G. Okumus, E. Oguz, M. Erdugan, A K Bilge
- P.099** **FREQUENCY OF PULMONARY MANIFESTATIONS IN SYSTEMIC SCLEROSIS WITH PULMONARY ARTERIAL HYPERTENSION**
A. Hamzaoui, H. Zoubeidi, F. Said, C. Abdelkefi, M. Lamloum, I. Ben Gorbel, M. Khanfir, M.H. Houman
- P.100** **PREVALENCE AND IMPACT OF PULMONARY HYPERTENSION IN SYSTEMIC SCLEROSIS**
A. Hamzaoui, H. Zoubeidi, F. Said, C. Abdelkefi, M. Lamloum, I. Ben Gorbel, T. Ben Salem, M. Khanfir, M.H. Houman
- P.101** **APPLICATION OF THE DETECT ALGORITHM IN A SINGLE CENTER**
A. Guillen-Del Castillo, E.L. Callejas-Moraga, V. Fonollosa-Pla, G. Garcia, J.F. Rodríguez-Palomares, A. Román, E. Domingo, M. López-Meseguer, C.P. Simeón-Aznar
- P.102** **DATA ABOUT PULMONARY HYPERTENSION IN THE SPANISH SCLERODERMA STUDY GROUP (SSSG) REGISTRY**
F. Garcia-Hernandez, M.J. Castillo-Palma, R. González-León, V. Fonollosa-Pla, C. Tolosa-vilella, D. Colunga-Argüelles, N. Ortego-Centeno, M. Rubio-Rivas, A.B. Madroñero-Vuelta, C.P. Simeón-Aznar, on behalf of RESCLE
- P.103** **MOLECULAR PHENOTYPING OF ENDOTHELIAL CELLS ISOLATED DIRECTLY FROM THE PULMONARY ARTERIES OF SYSTEMIC SCLEROSIS PATIENTS WITH PULMONARY ARTERIAL HYPERTENSION**
H. Farber, M. Trojanowska, S. Lenna, R. Lafyatis
- P.104** **HOW OFTEN DO WE NEED RIGHT HEART CATHETERIZATION IN THE FOLLOW-UP OF PATIENTS WITH SYSTEMIC SCLEROSIS?**
A. Akdogan, A. Erden, A. Sari, B. Armagan, L. Kilic, O. Karadag, U. Kalyoncu, S. Bilgen, S. Kiraz, I. Ertenli
- P.105** **SYSTEMIC SCLEROSIS-ASSOCIATED PULMONARY ARTERIAL HYPERTENSION: IS IT FEASIBLE TO DIAGNOSE AND MAINTAIN PATIENTS IN WORLD HEALTH ORGANIZATION (WHO) FUNCTIONAL CLASS II?**
F. Dall'Ara, S. Zingarelli, M.G. Lazzaroni, M. Rossi, A. Tincani, P. Airo
- P.106** **PREVALENCE AND PREDICTORS OF PULMONARY ARTERIAL HYPERTENSION IN A COHORT OF SYSTEMIC SCLEROSIS**
C. Costa, M. Rodrigues, M. Santiago, D. Jesus, P. Carvalho, M. Marques, A. Daniel, G. Eugénio, J. Ferreira, J. Silva, A. Malcata, J.A.P. Silva, M.J. Salvador
- P.107** **MILD VS EXTENSIVE INTERSTITIAL LUNG DISEASE IN SYSTEMIC SCLEROSIS (SSC): EXPERIENCE FROM A SINGLE CENTRE**
M. Gallardo, M. Scolnik, E. Lancioni, E.R. Soriano, L.J. Catoggio

- P.108 USEFULNESS OF BOSENTAN IN THE PREVENTION OF PULMONARY HYPERTENSION IN PATIENTS WITH SYSTEMIC SCLEROSIS**
I. Castellvi, C.P. Simeon-Aznar, M. Sarmiento, C. Geli, A. Guillen, C. Diaz-Torne, P. Moya, A. Laiz, M. Millan, H. Corominas, J.M. De Llobet, V. Fonollosa, J. Casademont
- P.109 AORTIC STENOSIS IS INCREASED IN SYSTEMIC SCLEROSIS PATIENTS WITH PULMONARY HYPERTENSION COMPARED TO OTHER TYPES OF PULMONARY HYPERTENSION**
M. Martin, O. Olivas, A. Quezada, M. Rodriguez, C. Merino, C. Jimenez, P. Escribano, L. Carmona, P. Carreira
- P.110 PERFORMANCE OF THE DETECT PROTOCOL FOR PULMONARY ARTERIAL DETECTION IN SYSTEMIC SCLEROSIS PATIENTS IN CLINICAL PRACTICE**
O. Olivas, B. Joven, B. Diaz-Anton, C. Jimenez, M. Martin, P. Escribano, E. Loza, P. Carreira
- P.111 A CASE OF SERONEGATIVE SYSTEMIC SCLEROSIS**
L. Câmara, J. Oliveira, S. Pinheiro
- P.112 NAILFOLD CAPILLAROSCOPY FINDINGS CAN HELP TO PREDICT THE PRESENCE AND SEVERITY OF INTERSTITIAL LUNG DISEASE IN PATIENTS WITH SYSTEMIC SCLEROSIS**
J. Caetano, F. Paula, M. Amaral, S. Oliveira, J. Delgado Alves
- P.113 SURVIVAL AND HEMODYNAMICS IN PATIENTS WITH SCLERODERMA ASSOCIATED PULMONARY VENOUS HYPERTENSION**
K. Bourji, B. Kelemen, S. Mathai, E. Pigatto, E. Zanatta, F. Cozzi, P. Hassoun
- P.114 DETECT ALGORITHM AND EARLY DIAGNOSIS OF PULMONARY ARTERIAL HYPERTENSION IN SYSTEMIC SCLEROSIS: A SINGLE CENTRE EXPERIENCE**
M.R. Pozzi, D. De Stasio, A. Frattola, A. Vincenzi, C. Valena, F. Bonomi, M. Riva, G. Erba, G. Grassi
- P.115 DESIGN OF A RANDOMIZED, PLACEBO-CONTROLLED CLINICAL TRIAL OF NINTEDANIB IN PATIENTS WITH SYSTEMIC SCLEROSIS-ASSOCIATED INTERSTITIAL LUNG DISEASE**
O. Distler, J. Distler, K.K. Brown, V. Cottin, J. Varga, C. Coeck, H. Schmidt, K. Highland
- P.116 CORRELATION BETWEEN THE SERUM LEVELS OF N-TERMINAL PRO-BRAIN NATRIURETIC PEPTIDE AND PULMONARY ARTERIAL PRESSURE IN A LONGITUDINAL COHORT OF PATIENTS WITH SYSTEMIC SCLEROSIS**
A. Belotti Masserini, F. Cagnoni, E. Bontempelli, C. Cavalleri, M. Destro
- P.117 WITHDRAWN**
- P.118 CIRCULATING THYROXINE SERUM LEVELS ARE ASSOCIATED WITH SYSTOLIC PULMONARY ARTERIAL PRESSURE IN SYSTEMIC SCLEROSIS**
G. Bagnato, A. Fiorenza, S. Sorbara, W.N. Roberts, R. Certo, R.M. Ruggeri, M. Cusmà Piccione, F. Trimarchi, S. Carerj, G.F. Bagnato
- P.119 CAN QUANTITATIVE CHEST CT PREDICT THE MORTALITY IN SYSTEMIC SCLEROSIS ASSOCIATED INTERSTITIAL LUNG DISEASE? THE ANSWER FROM RISK PREDICTION MODELS**
A. Ariani, V. Seletti, E. Bravi, M. Saracco, S. Parisi, F. De Gennaro, P. Caramaschi, M. Silva, V. Alfieri, E. Bonati, F.C. Bodini, C.A. Scirè, M. Aiello, D. Santilli, F. Lumetti, E. Arrigoni, R. Pellerito, E. Fusaro, A. Chetta, N. Sverzellati
- P.120 THE SURVIVAL AND PROGNOSTIC FACTORS OF PATIENTS WITH SYSTEMIC SCLEROSIS: EXPERIENCE OF TWO CENTERS**
A. M. Onat, O. Zengin, S. Dönmez, B. Kisacik, Ö. N. Pamuk

CARDIAC

- P.121** **LEFT HEART DISEASE AS COMMON MANIFESTATION IN SYSTEMIC SCLEROSIS WITH PULMONARY HYPERTENSION**
Y. Yamasaki, K. Suzuki, Y. Asari, K. Tsuchida, Y. Akashi, S. Ozaki, H. Yamada
- P.122** **IMPACT OF CARDIAC MAGNETIC RESONANCE IMAGING WITH T1 MAPPING AND MULTI-B VALUE DIFFUSION-WEIGHTED SEQUENCES IN SYSTEMIC SCLEROSIS FOR THE ASSESSMENT OF MYOCARDIAL MICROSCOPIC FIBROSIS AND PERFUSION**
B. Terrier, H. Gouya, A. Berezne, A. Regent, P. Cohen, L. Guillevin, C. Le Jeunne, P. Legmann, O. Vignaux, L. Mouthon
- P.123** **CYCLOPHOSPHAMIDE CARDIOTOXICITY - A CLINICAL CASE.**
L. Teixeira, F. Vinagre, J. Canas da Silva
- P.124** **A CASE OF ACUTE AND COMPLICATED HEART INVOLVEMENT IN PROGRESSIVE SYSTEMIC SCLEROSIS**
G. Seskute, R. Ruginiene, A. Cypiene, A. Laucevicus, I. Butrimiene
- P.125** **CORONARY MICROANGIOPATHY IN PATIENTS WITH SYSTEMIC SCLEROSIS: PROGRESSION AFTER 6 YEARS.**
E. Pigatto, G. Famoso, E. Zanatta, M. Favaro, F. Oliviero, P. Polito, K. Bourji, L. Punzi, F. Tona, F. Cozzi
- P.126** **NT PROBNP LEVELS IN SYSTEMIC SCLEROSIS PATIENTS – A SUBCLINICAL NECESSITY**
R. Nichitean, A. Petcu, S. Rednic
- P.127** **ANTIIPHOSPHOLIPID ANTIBODIES IN SYSTEMIC SCLEROSIS AND THEIR ASSOCIATION WITH ISCHEMIC ARTERIAL EVENTS AND ATHEROSCLEROSIS**
S. Coskun, E. Svenungsson, A. Antovic, K. Elvin, A. Nordin
- P.128** **VENTRICULAR ARRHYTHMIAS SUBSTRATE IN PATIENTS WITH SYSTEMIC SCLEROSIS**
L. Muresan, I. Oancea, A. Petcu, C. Pamfil, C. Muresan, M. Rinzis, D. Zdrenghea, S. Rednic
- P.129** **IS NT-PRO BNP A FUTURE ARRHYTHMIA MARKER IN PATIENTS WITH SYSTEMIC SCLEROSIS?**
L. Muresan, A. Petcu, C. Pamfil, C. Muresan, M. Rinzis, D. Zdrenghea, S. Rednic
- P.130** **CHARACTERISTICS OF SYSTEMIC SCLEROSIS PATIENTS WITH ARRHYTHMIAS AND CONDUCTION DISORDERS**
L. Muresan, A. Petcu, C. Pamfil, C. Muresan, M. Rinzis, D. Zdrenghea, S. Rednic
- P.131** **SERUM URIC ACID LEVEL, CARDIOVASCULAR RISK AND ORGAN INVOLVEMENT IN SYSTEMIC SCLEROSIS**
M. Madej, E. Morgiel, A. Luczak, P. Wojtala, P. Wiland
- P.132** **MYOCARDIAL FIBROSIS IN SYSTEMIC SCLEROSIS . ABOUT A NEW CASE.**
O. Mkinsi
- P.133** **A SICK SINUS SYNDROME IN A PATIENT WITH SYSTEMIC SCLEROSIS**
S.O. Jung, Y.S. Kim, H.S. Kim
- P.134** **SUBCLINICAL ATHEROSCLEROSIS IN SYSTEMIC SCLEROSIS: NOT LESS FREQUENT THAN RHEUMATOID ARTHRITIS AND NOT DETECTED WITH CARDIOVASCULAR RISK INDICES**
N. Inanc, G. Ozen, F. Korkmaz, M. Sunbul, M. Ozmen, S. Akar, R. Deniz, S. Donmez, O.N. Pamuk, P. Atagunduz, K. Tigen, H. Direskeneli
- P.135** **FREQUENCY OF CARDIAC MANIFESTATIONS IN PATIENTS WITH SYSTEMIC SCLEROSIS AND PULMONARY ARTERIAL HYPERTENSION**
A. Hamzaoui, H. Zoubeidi, F. Said, C. Abdelkefi, M. Lamoum, I. Ben Gorbel, M. Khanfir, M.H. Houman
- P.136** **RIGHT VENTRICULAR INVOLVEMENT IN A PATIENT WITH SYSTEMIC SCLEROSIS MIMICKING ARRHYTHMOGENIC RIGHT VENTRICULAR CARDIOMYOPATHY**
A. Akdogan, A. Erden, L. Kilic, L. Sahiner, I. Ertenli
- P.137** **EVALUATING CARDIOVASCULAR RISK FACTORS IN PATIENTS WITH SYSTEMIC SCLEROSIS**
R. Encarnado Assis, S. Cunha Martins, A. R. Sanches, J. Garcia, M. Carvalho, F. Pimenta
- P.138** **CARDIAC INVOLVEMENT IN SYSTEMIC SCLEROSIS – A PORTUGUESE REALITY**
A. Duarte, I. Cordeiro, S. Sousa, L. Teixeira, J. Canas Da Silva, A. Cordeiro, M.J. Santos

OUTCOMES, QUALITY OF LIFE, PSYCHOLOGICAL & SOCIAL

- P.139 MALIGNANCY RISK IN SCLERODERMA PATIENTS TREATED WITH CYCLOPHOSPHAMIDE**
N. Yilmaz, H. Emmungil, S. Gucenmez, G. Ozen, F. Yildiz, A. Balkarli, G. Kimyon, B. N. Coskun, I. Dogan, O.N Pamuk, S. Yasar, G. Y. Cetin, A. Yazici, S. Ergülü Esmen, Y. Cagatay, S. Yilmaz, A. Cefle, M. Sayarlioglu, T. Kasifoglu, O. Karadag, Y. Pehlivan, E. Dalkılıç, B. Kisacik, V. Cobankara, E. Erken, H. Direskeneli , K. Aksu , S. Yavuz
- P.140 OCCURRENCE OF ORGAN INVOLVEMENT IN THE EARLY PHASE OF SYSTEMIC SCLEROSIS: A LARGE COHORT STUDY**
W. Van Den Hombergh, H.K.A. Knaapen-Hans, F.H.J. Van Den Hoogen, J. Fransen, M.C. Vonk
- P.141 EARLY SIGNS, SYMPTOMS AND AUTO-ANTIBODIES TO PREDICT DIFFUSE CUTANEOUS OR LIMITED CUTANEOUS SYSTEMIC SCLEROSIS AT FIRST PRESENTATION**
W. Van Den Hombergh, P.E. Carreira, H.K.A. Knaapen-Hans, F.H.J. Van Den Hoogen, J. Fransen, M.C. Vonk
- P.142 RISK FACTORS FOR THE DEVELOPMENT OF GANGRENE IN SYSTEMIC SCLEROSIS PATIENTS WITH DIGITAL ULCER DISEASE: DATA FROM THE DUO REGISTRY**
Y. Allanore, C.P. Denton, T. Krieg, P. Cornelisse, D. Rosenberg, B. Schwierin, M. Matucci-Cerinic
- P.143 PATIENTS' PERSPECTIVES ON LIVING WITH SYSTEMIC SCLEROSIS: A SEMI-STRUCTURED INTERVIEW STUDY**
D. Sumpton, V. Thakkar, S. O'Neill, D. Singh-Grewal, J. Craig, A. Tong
- P.144 FACTORS INFLUENCING RHEUMATOLOGISTS DECISION ABOUT REFERRAL OF SSC PATIENTS TO HEALTH PROFESSIONALS**
J.K. Stöcker, E.H.C. Cup, M.W.G. Nijhuis-Van Der Sanden, J.B. Staal, M.C. Vonk , F.H.J. Van Den Hoogen, C.H.M. Van Den Ende
- P.145 LATE-ONSET SYSTEMIC SCLEROSIS: CLINICAL PICTURE AND OUTCOME**
C. Stagnaro, A. D'Ascanio, A. Della Rossa, M. Mosca
- P.146 CHANGES IN CHARACTERISTICS OF THE FIRST PRESENTATION IN PATIENTS WITH SYSTEMIC SCLEROSIS – A SIGN OF IMPROVING AWARENESS**
A. Soare, A.M. Gherghe, R. Dobrota, M. Gorga, A. Radu, R. Oneata, S. Pintilie, S. Magda, T. Constantinescu, R. Jurcut, M. Sasu, L. Macovei, M. Milicescu, I. Ancuta, V. Stoica, M. Bojinca, C. Mihai
- P.147 TREATMENT OF DIGITAL ULCERS IN SYSTEMIC SCLEROSIS IN (CURRENT) CLINICAL PRACTICE. RESULTS OF A HEALTHCARE RESEARCH STUDY**
G. Riemekasten, S. Beissert, J. H.W. Distler, A. Kreuter, G. Setzer, U. Müller-Ladner
- P.148 EVOLUTION OF SYMPTOMS IN LIMITED AND DIFFUSE FORMS OF SYSTEMIC SCLEROSIS (RESULTS OF FIVE-YEAR STUDY)**
V. Semenov, T. Lysunets, O. Kuryata
- P.149 THE FREQUENCY OF SECONDARY SJOGREN SYNDROME IN SCLERODERMA**
P. Wiland, A. Sebastian, A. Szachowicz, P. Woytala, E.J. Mroczek
- P.150 SURVIVAL, CAUSES OF DEATH AND PROGNOSIS FACTORS IN SYSTEMIC SCLEROSIS IN ARGENTINA**
P. Sansinanea, J. Marcos, A. Salas, C. Costi, C. Pena, M. Garcia
- P.151 OPTIMIZING SCLERODERMA CENTERS OF EXCELLENCE: PERSPECTIVES FROM PATIENTS AND SYSTEMIC SCLEROSIS (SSC) EXPERTS**
V. Jaegar, K. Fligelstone, N. Baldwin, R. Sims, J. Welling, A. Aubin, R. Burrill, K. Connolly, J.K. Gordon, T. Frech, T. Ngcozana, J.A. Lasky, U.A. Walker, L.A. Saketkoo
- P.152 CAN THE SELF-EFFICACY TO MANAGE CHRONIC DISEASE SCALE BE USED TO EVALUATE SELF-EFFICACY IN PATIENTS WITH SYSTEMIC SCLEROSIS? A SCLERODERMA PATIENT-CENTERED INTERVENTION NETWORK COHORT STUDY**
K.E. Riehm, L. Kwakkenbos, M. Carrier, W. Nielson, K. Nielsen, B.D. Thombs
- P.153 DEMOGRAPHIC AND DISEASE CORRELATES OF CLINICALLY SIGNIFICANT FATIGUE IN SYSTEMIC SCLEROSIS: PRELIMINARY EVIDENCE USING CASE-DEFINITION CRITERIA**
D.B. Rice, L. Kwakkenbos, R. Steele, M. Hudson, M. Baron, B.D. Thombs, Canadian SSc Research Group
- P.154 MORTALITY ANALYSIS IN A COHORT OF SYSTEMIC SCLEROSIS PATIENTS**
R. Paz, R. Sousa Almeida, A. Alves Oliveira, P. M. Pego, Y. Abuowda, C. Santos, J. Matos Costa
- P.155 THE EPIDEMIOLOGY OF SCLERODERMA IN NORTHWESTERN PART OF TURKEY: 12 YEARS' FOLLOW-UP DATA**
O. Pamuk, S. Donmez

- P.156 SYSTEMIC SCLEROSIS PATIENTS ON INTENSIVE CARE UNIT - REASONS FOR ADMISSION AND DETERMINANTS OF OUTCOME**
S. Nihtyanova, F. Figorilli, R. Sinharay, C. Denton, B. Agarwal, V. Ong
- P.157 NURSE-LED RAPID ACCESS DIGITAL ULCER CLINIC: AN AUDIT OF UK PATIENT COHORT EXPERIENCE**
T. Ngcozana, C.P Denton, V. Ong
- P.158 PATIENT'S PERSPECTIVES AND EXPERIENCES OF LIVING WITH SYSTEMIC SCLEROSIS – A REVIEW OF QUALITATIVE STUDIES**
A. Nakayama, D.J. Tunnicliffe, V. Thakkar, D. Singh-Grewal, S. O'Neill, J. Craig, A. Tong
- P.159 PROGNOSIS AND SURVIVAL ARE DIFFERENT IN EARLY AND LATE ONSET SYSTEMIC SCLEROSIS: OBSERVATIONS OF 340 HUNGARIAN PATIENTS OF A SINGLE CENTER**
G. Nagy, T. Minier, C. Varjú, K. T. Kovács, V. Lóránd, V. Hermann, L. Czirják, G. Kumánovics
- P.160 TRANSITION OF CARE AND LONG-TERM OUTCOMES OF JUVENILE SYSTEMIC SCLEROSIS DURING ADULTHOOD: RESULTS FROM A FRENCH SINGLE-CENTER CASE-CONTROL STUDY**
F.X. Mauvais, B. Bader - Meunier, A. Bérezné, G. Bussone, C. Bodemer, I. Guillevin, P. Quartier, L. Mouthon
- P.161 SYSTEMIC SCLEROSIS: AN OUTPATIENT CLINIC REVIEW**
M. Moreira, J. Silva, P. Monteiro, C. Coelho, C. Costa, C. Silva, P. Ferreira, V. Paixão Dias
- P.162 THE FACE REFLECTING SYSTEMIC SCLEROSIS - MOUTH HANDICAP IN SYSTEMIC SCLEROSIS SCALE**
P. Monteiro, M. Guerra, M. Moreira, C. Silva, P. Ferreira, A. Seixas, C. Coelho, C. Costa, T. Videira, P. Pinto, V. Paixão Dias
- P.163 PSYCHOMETRIC PROPERTIES OF THE SOCIAL APPEARANCE ANXIETY SCALE IN PATIENTS WITH LIMITED AND DIFFUSE SYSTEMIC SCLEROSIS: A SCLERODERMA PATIENT-CENTERED INTERVENTION NETWORK COHORT STUDY**
S. D. Mills, S. Gholizadeh, R. S. Fox, L. R. Jewett, M. Carrier, L. Kwakkenbos, K. Gottesman, S. C. Roesch, B. D. Thombs, V. L. Malcarne, SPIN Investigators
- P.164 FATIGUE IN SCLERODERMA: A CANADIAN SCLERODERMA RESEARCH GROUP STUDY INVESTIGATING SOCIODEMOGRAPHIC AND DISEASE CORRELATES**
B. Levis, L. Kwakkenbos, M. Hudson, M. Baron, B.D. Thombs
- P.165 ASSOCIATIONS OF CLINICAL DISEASE CHARACTERISTICS WITH PROMIS-29 DOMAINS: A SCLERODERMA PATIENT-CENTERED INTERVENTION NETWORKS (SPIN) COHORT STUDY**
L. Kwakkenbos, B.D. Thombs, S.J. Bartlett, M.E. Carrier, M. Hudson, L. Mouthon, V.L. Malcarne, M. Sauvé, D. Khanna
- P.166 CONSTRUCT VALIDITY OF THE PROMIS-29 IN SYSTEMIC SCLEROSIS: A SCLERODERMA PATIENT-CENTERED INTERVENTION NETWORK (SPIN) COHORT STUDY**
L. Kwakkenbos, B.D. Thombs, S.J. Bartlett, M.E. Carrier, M. Hudson, L. Mouthon, V.L. Malcarne, M. Sauvé, D. Khanna
- P.167 JUVENILE LIMITED SCLERODERMA IN ONE PAEDIATRIC RHEUMATOLOGY CENTRE IN THE UNITED ARAB EMIRATES**
K. Khawaja, M. Almaini
- P.168 THE VALIDITY AND RELIABILITY OF ONLINE OBITUARIES AS A SOURCE OF MORTALITY DATA IN SYSTEMIC SCLEROSIS**
M. Soowamber, J. T. Granton, F. Bavaghar-Zaeimi, S. Johnson
- P.169 THERE IS A NEED FOR NEW SYSTEMIC SCLEROSIS SUBSET CRITERIA. A CONTENT ANALYTIC APPROACH**
S. Johnson, M. Soowamber, J. Fransen , D. Khanna, F. H. J. Van Den Hoogen, M. Baron, M. Matucci-Cerinic, C. P. Denton, T. A. Medsger Jr. , P. E. Carreira, G. Riemekasten, J. Hw. Distler, A. Gabrielli , V. D. Steen, L. Chung, R. Silver, J. Varga, U. Müller-Ladner, M. C. Vonk, U. A. Walker, F. Wollheim, A.L. Herrick, D. E. Furst, L. Czirjak, O. Kowal-Bielecka, F. Del Galdo, M. Cutolo, N. Hunzelmann, C. Murray, I. Foeldvari, L. Mouthon, N. Damjanov, B. Kahaleh, T. Frech, S. Assassi, L. Ann Saketkoo, J. E. Pope
- P.170 DEVELOPMENT AND VALIDATION OF THE BODY CONCEALMENT SCALE FOR SCLERODERMA (BCSS)**
L. Jewett, V.L. Malcarne, L. Kwakkenbos, D. Harcourt, N. Rumsey, A. Körner, R.J. Steele, M. Hudson, M. Baron, J.A. Haythornthwaite, L. Heinberg, F.M. Wigley
- P.171 THE EXPERIENCE OF LIVING WITH VISIBLE DIFFERENCES FROM SCLERODERMA**
L. Jewett, V.C. Delisle, V.L. Malcarne, S. Peláez, M. Hudson, B.D. Thombs
- P.172 PREDICTORS OF DISABILITY IN SYSTEMIC SCLEROSIS: A STUDY FROM THE DESSCIPHER PROJECT**
V. Jaeger, G. Abignano, Y. Allanore, L. Ananieva, C. Ancuta, J. Avouac, F. Cozzi, L. Czirják, F. Del Galdo, C. Denton, O. Distler, I. Foeldvari, M. Frerix, A. Gabrielli, B. Garay Toth, S. Guiducci, N. Hunzelmann, D. Huscher, B. Krummel-Lorenz, V. Lorand , B. Maurer, M. Matucci-Cerinic, U. Müller-Ladner, S. Nihtyanova, S. Rednic, V. Riccieri, G. Riemekasten, T. Schmeiser, E. Siegert, I.H. Tarner, A. Vacca, S. Vettori, S. Yavuz, U.A. Walker, on Behalf of the Desscipher Consortium and Contributing Eustar Centres

- P.173** **INCIDENCE AND PREDICTORS OF CUTANEOUS MANIFESTATIONS DURING THE EARLY COURSE OF SYSTEMIC SCLEROSIS - A 10 YEAR LONGITUDINAL STUDY FROM THE EUSTAR DATABASE**
V. Jaeger, E.G. Wirz, Y. Allanore, G. Riemekasten, E. Hachulla, O. Distler, P. Airo, P.E. Carreira, M. Tikly, S. Vettori, A. Balbir Gurman, N. Damjanov, U. Müller-Ladner, J.H.W. Distler, M. Li, P. Häusermann, U.A. Walker on behalf of EUSTAR Collaborators
- P.174** **CANCER RISK IN EGYPTIAN PATIENTS WITH SYSTEMIC SCLEROSIS**
M. Hassanien, G. Husein, N. Mohamed
- P.175** **SYSTEMIC SCLEROSIS INPATIENT MORTALITY HAS NOT IMPROVED FROM 1995-2011. RESULTS FROM A NATIONAL IRISH AUDIT OF SCLERODERMA CO-MORBIDITIES**
L. Harty, D. Fitzgerald, J. Ryan, M. Henry, S. Harney
- P.176** **EXPLORING THE SOURCES OF EMOTIONAL DISTRESS AND MANAGEMENT STRATEGIES AMONG PEOPLE LIVING WITH SCLERODERMA THROUGH FOCUS GROUPS: A SCLERODERMA PATIENT-CENTERED INTERVENTION NETWORK STUDY**
S. Gumuchian, V. Delisle, S. Peláez, M-E. Carrier, L. Jewett, G. El-Baalbaki, L. Kwakkenbos, B. Thombs, S. Bartlett
- P.177** **CLINICAL AND IMMUNOLOGICAL FEATURES IN A COHORT OF 228 SYSTEMIC SCLEROSIS**
C. Grange, C. Mausservey, C. Khouatra, D. Jullien, P. Seve, N. Fabien, J.C. Lega, A. Hot
- P.178** **RESTLESS LEG SYNDROME PREVALENCE IS NOT INCREASED IN SYSTEMIC SCLEROSIS PATIENTS**
M. Gonçalves, V. C. Romão, A. M. Castro, C. Ponte, H. Canhão, C. Resende, J. A. Pereira da Silva
- P.179** **A PSYCHOMETRIC ANALYSIS OF THE SOCIAL INTERACTION ANXIETY SCALE (SIAS-6) IN SYSTEMIC SCLEROSIS: RESULTS FROM THE SCLERODERMA PATIENT-CENTERED INTERVENTION NETWORK (SPIN) COHORT**
S. Gholizadeh, S.D. Mills, R.S. Fox, L.R. Jewett, S.C. Roesch, K. Gottesman, L. Kwakkenbos, M.E. Carrier, B.D. Thombs, V.L. Malcarne
- P.180** **VALIDATION OF A ROMANIAN VERSION OF DURUOZ HAND INDEX QUESTIONNAIRE FOR PATIENTS WITH SYSTEMIC SCLEROSIS**
R. Capota, AM. Gherghe, AM. Soare, RC. Dobrota, M. Gorga, R. Oneata, M. Sasu, M. Milicescu, L. Macovei, I. Ancuta, C. Ciofu, M. Bojinca, V. Stoica, C. Mihai
- P.181** **DEVELOPMENT OF A JUVENILE SYSTEMIC SCLEROSIS RESPONSE INDEX (JSSRI)**
I. Foeldvari, G. Zoltan, E. Baildam, E. D. Batu, M. Blakley, M. Cakan, M. Curran, A. Kienast, K. Fligelstone, D. Nemkova, C. Pilkington, N. Ruperto, M. Tsinti, E. Tsitsami, K. Urbanvica, T. Constantin
- P.182** **PERFORMANCE OF THE ADULT SYSTEMIC SCLEROSIS CLASSIFICATION IN JUVENILE SYSTEMIC SCLEROSIS PATIENTS. RESULTS FROM THE JUVENILE SYSTEMIC SCLEROSIS INCEPTION COHORTE – WWW.JUVENILE-SCLERODERMA.COM**
I. Foeldvari, J. Klotsche, V. Stanevica, E. Alexeeva, M. Katsicas, M. Teresa Terreri, A.P. Sakamoto 6, R. Cimaz, M. Kostik, T. Avcin, M. Jose Santos, M. Moll, D. Nemkova, F. Sztajn bok, J. Brunner, S. Nielsen, T. Kallinich, K. Minden, M. Janarthanam, Y. Uziel, Wa. Sifuentes-Giraldo, D. Eleftheriou, K. Torok, N. Helmus
- P.183** **IS THERE A DIFFERENCE IN THE PRESENTATION OF DIFFUSE AND LIMITED SUBTYPE OF JUVENILE SYSTEMIC SCLEROSIS IN CHILDHOOD? RESULT FROM THE JUVENILE SCLERODERMA INCEPTION COHORT WWW.JUVENILE-SCLERODERMA.COM**
I. Foeldvari, J. Klotsche, V. Stanevica, E. Alexeeva, M. Katsicas, M. Teresa Terreri, A.P. Sakamoto 6, R. Cimaz, M. Kostik, T. Avcin, M. Jose Santos, M. Moll, D. Nemkova, F. Sztajn bok, J. Brunner, S. Nielsen, T. Kallinich, K. Minden, M. Janarthanam, Y. Uziel, Wa. Sifuentes-Giraldo, D. Eleftheriou, K. Torok, N. Helmus
- P.184** **UPDATE ON THE JUVENILE SYSTEMIC SCLEROSIS INCEPTION COHORT PROJECT. CHARACTERISTICS OF THE FIRST 50 PATIENTS AT FIRST ASSESSMENT. WWW.JUVENILE-SCLERODERMA.COM**
I. Foeldvari, J. Klotsche, V. Stanevica, E. Alexeeva, M. Katsicas, M. Teresa Terreri, A.P. Sakamoto 6, R. Cimaz, M. Kostik, T. Avcin, M. Jose Santos, M. Moll, D. Nemkova, F. Sztajn bok, J. Brunner, S. Nielsen, T. Kallinich, K. Minden, M. Janarthanam, Y. Uziel, Wa. Sifuentes-Giraldo, D. Eleftheriou, K. Torok, N. Helmus
- P.185** **PREVALENCE OF ANXIETY AND DEPRESSION IN A SYSTEMIC SCLEROSIS COHORT**
J. Ferreira, G. Eugênio, A. Daniel, J. Rovisco, C. Costa, M. Rodrigues, S. Serra, C. Duarte, A. Malcata, M. Salvador
- P.186** **FATIGUE, BUT NOT SLEEP, IS A PROBLEM IS SYSTEMIC SCLEROSIS PATIENTS**
J. Ferreira, G. Eugênio, A. Daniel, J. Rovisco, C. Costa, M. Rodrigues, S. Serra, C. Duarte, A. Malcata, M. Salvador
- P.187** **MALIGNANT NEOPLASTIC DISEASE IN PATIENTS WITH SYSTEMIC SCLEROSIS**
M.M. Popa, R. Dobrota, A. Soare, A.M. Gherghe, M. Gorga, M. Sasu, L. Macovei, M. Milicescu, I. Ancuta, V. Stoica, M. Bojinca, C. Mihai
- P.188** **DIFFUSE CUTANEOUS SYSTEMIC SCLEROSIS (DCSSC) REFERRAL AND DIAGNOSIS: RESULTS OF A SURVEY OF HEALTHCARE PROVIDERS**
O. Distler, Y. Allanore, C. Denton, M. Matucci-cerinic, J. Pope, B. Hinzmans, S. Briody, J. de Oliveira Pena, D. Khanna

- P.189 PATIENT PERCEPTION OF DISEASE BURDEN IN DIFFUSE CUTANEOUS SYSTEMIC SCLEROSIS (DCSSC)**
O. Distler, Y. Allanore, C. Denton, M. Matucci-cerinic, J. Pope, B. Hinzmann, S. Briody, J. de Oliveira Pena, D. Khanna
- P.190 THE EXPERIENCE OF BEING DIAGNOSED AND LIVING WITH SCLERODERMA: IMPROVING COMMUNICATION BETWEEN PATIENTS AND HEALTH CARE PROFESSIONALS**
V. Delisle, L. Jewett, V. Malcarne, M. Hudson, B. Thombs
- P.191 THE SCLERODERMA SUPPORT GROUP SURVEY: UNDERSTANDING PEOPLE'S EXPERIENCES WITH SCLERODERMA SUPPORT GROUPS**
V. Delisle, S. Gumuchian, V. Malcarne, G. El-Baalbaki, S. Pelaez, B. Thombs
- P.192 ANOSMIA HERALDING THE ONSET OF MIXED CONNECTIVE TISSUE DISEASE IN A PATIENT WITH SYSTEMIC SCLEROSIS**
L. Damian, S. Rednic, I. Filipescu, A. Maniu, S.P. Simon, A. Petcu, E. Candrea, C. Pamfil
- P.193 PSYCHOLOGICAL DIMENSIONS IN SCLERODERMA: SYMPTOMS, REPRESENTATION OF DISEASE, SOCIAL SUPPORT, PERCEPTION OF PAIN**
P. Colombelli, F. Pierazzuoli, E. Gatti, A. Belotti Masserini, F. Cagnoni, G.P. Dognini, A. Besozzi, M. Destro
- P.194 SYSTEMIC SCLEROSIS AND CANCER: THE EXPERIENCE OF AN ITALIAN TERTIARY REFERRAL RHEUMATOLOGY CENTRE**
M. Colaci, C. Vacchi, A. Manfredi, M. Sebastiani, D. Giuggioli, C. Ferri
- P.195 AN INTERNATIONAL COLLABORATION TO COLLECT DATA AND DEVELOP ONLINE INTERVENTIONS FOR SCLERODERMA PATIENTS AND AN UPDATE FROM THE SCLERODERMA PATIENT-CENTERED INTERVENTION NETWORK (SPIN)**
M. Carrier, L. Kwakkenbos, B. Thombs, SPIN Investigators
- P.196 SYSTEMIC SCLEROSIS IS ASSOCIATED WITH POOR SLEEP QUALITY AND DECREASED QUALITY OF LIFE**
V. C Romão, M.J. Gonçalves, A. Castro, C. Ponte, H. Canhão, C. Resende, J.A. Pereira Da Silva
- P.197 VASCULOPATHY AND DISABILITY IN SYSTEMIC SCLEROSIS PATIENTS TREATED WITH BOSENTAN**
E. Rezus, A. Burlui, A. Cardoneanu, C. Banu
- P.198 SHORT TERM NAILFOLD VIDEOCAPILLAROSCOPY (NVC) EVALUATION MAY NOT REFLECT DIGITAL ULCERS (DU) CHANGES IN PATIENTS WITH SYSTEMIC SCLEROSIS (SSC)**
C. Bruni, T. Ngcozana, F. Braschi, S. Guiducci, S. Bellando-Randone, T. Barskova, G. Piemonte, L. Benelli, L. Tofani, C.P. Denton, D.E. Furst, M. Matucci-Cerinic
- P.199 PATIENT- REPORTED OUTCOMES REFLECT CHANGES IN DIGITAL ULCER (DU) STATUS IN PATIENTS WITH SYSTEMIC SCLEROSIS (SSC)**
C. Bruni, T. Ngcozana, F. Braschi, S. Guiducci, S. Bellando-randone, G. Piemonte, L. Benelli, L. Tofani, C.P. Denton, D.E. Furst, M. Matucci-Cerinic
- P.200 ACCESSIBILITY AND ADHERENCE IN PATIENTS WITH SCLERODERMA RESIDENTS IN BUENOS AIRES**
C. Bento, A. Cusa
- P.201 MORTALITY IN PATIENTS WITH SYSTEMIC SCLEROSIS- A SINGLE CENTER EXPERIENCE**
A. Balbir-Gurman, H. Attamna, D. Markovits, M. Nahir, N. Schultz, V. Shataylo, Y. Braun-Moscovici
- P.202 EXERCISE HABITS AND ASSOCIATED FACTORS IN SCLERODERMA: A SCLERODERMA PATIENT-CENTERED INTERVENTION NETWORK (SPIN) COHORT STUDY**
M. Azar, D. Rice, L. Kwakkenbos, M.E. Carrier, I. Shrier, M. Hudson, B. Thombs, SPIN Investigators
- P.203 EXPLORING THE PHYSICAL AND PSYCHOSOCIAL FACTORS THAT IMPACT QUALITY OF LIFE IN SYSTEMIC SCLEROSIS (SSC)**
B. Alcaccer-Pitarch, A. Redmond, M. Buch, F. Del Galdo, AM. Keenan
- P.204 HIGH RESOLUTION MANOMETRY FACE TO FACE WITH THE THE SSC_GIT 1.0 QUESTIONNAIRES IN SYSTEMIC SCLEROSIS PATIENTS**
H. Abozaid, H. Imam, M. Abdelaziz, D. El Hammady, N. Fathi
- P.205 THE ERASMUS SYNDROME : EXPOSURE TO SILICA AND SYSTEMIC SCLEROSIS**
A. Abdessemed, S. Slimani, N. Khaldoun, F. Bougrina, S. Bencheikh, N. Ait Belabas, A. Djoudi, N. Brahimi, A. Ladjouze
- P.206 CANCER AND SYSTEMIC SCLEROSIS**
A. Abdessemed, N. Khaldoun, A. Djoudi, N. Ait Belabas, F. Bougrina, N. Brahimi, A. Ladjouze

IMAGING

- P.207** **PRELIMINARY MUSCULOSKELETAL ULTRASOUND (MSUS)
ULCER DEFINITION DOES NOT CORRELATE WITH VISUAL
OBSERVATION IN SYSTEMIC SCLEROSIS (SSC) PATIENTS**
Y. Suliman, V. Ranganath, J. Fitzgerald, D. Elashoff, N. Jackson, S. Kafaja, D.E. Furst
- P.208** **MUSCULOSKELETAL ULTRASOUND FINDINGS IN SYSTEMIC
SCLEROSIS: CORRELATION WITH CLINICAL ASPECTS AND
SEROLOGICAL BIOMARKERS**
K. Stefanantoni, V. Iorgovenau, M.C. Saturno, A. Pecani, I. Sciarra, M. Vasile, C. Alessandri, A. Iagnocco, V. Riccieri
- P.209** **COMPARISON OF SYNOVIAL INFLAMMATION BETWEEN
SYSTEMIC SCLEROSIS AND RHEUMATOID ARTHRITIS BY
MAGNETIC RESONANCE IMAGING OF HANDS**
B. Stamenkovic, A. Stankovic, J. Nedovic, S. Stojanovic, V. Zivkovic, I. Aleksic, S. Milenkovic, N. Damjanov
- P.210** **QUANTIFYING DIGITAL ULCERS IN SYSTEMIC SCLEROSIS:
REPEATABILITY AND REPRODUCIBILITY OF SOFTWARE-
BASED SURFACE AREA MEASUREMENT**
V. Simpson, G. Dinsdale, M. Hughes, A.L Herrick
- P.211** **ASSESSMENT OF BONE INVOLVEMENT OF DISTAL FOREARM BY
HR-PQCT IN PATIENTS WITH DIFFUSE SYSTEMIC SCLEROSIS**
P. Sampaio-Barros, M. M. Sampaio-Barros, L. Takayama, J. C. Alvarenga, A. P. L. Assad, R. M. R. Pereira
- P.212** **COMPARISON BETWEEN MODIFIED RODNAN SKIN SCORE
AND HIGH-FREQUENCY SKIN ULTRASOUND IN EARLY
IDENTIFICATION OF SKIN INVOLVEMENT IN SYSTEMIC
SCLEROSIS PATIENTS**
B. Ruaro, A. Sulli, E. Bernero, M.A. Cimmino, E. Alessandri, M. Cutolo
- P.213** **SONOGRAPHY SIGNS OF INTERSTITIAL LUNG DISEASE
RELATED WITH SYSTEMIC SCLEROSIS EVALUATED BY
CHEST ULTRASOUND: A COMPARISON BETWEEN
HONEYCOMBING AND GROUND GLASS HIGH RESOLUTION
CHEST CT FINDINGS**
C. Rotondo, A. Chialà, M.G. Anelli, M. Nivuori, L. Coladonato, C. Fiorentini, S. Perniola, G. Lapadula, F. Iannone
- P.214** **ECHOSONOGRAPHY OF SKIN FINGERS IN PATIENTS WITH
SYSTEMIC SCLEROSIS**
S. Prodanovic, G. Radunovic, N. Damjanov
- P.215** **COMPARISON OF LASER SPECKLE CONTRAST ANALYSIS AND
CAPILLAROSCOPY IN SYSTEMIC SCLEROSIS PATIENTS WITH
DIGITAL ULCERS**
R. Cimino, C. Pintadi, S. Mazzuca
- P.216** **CAPILLAROSCOPIC ALTERATIONS IN DERMATOMYOSITIS
AND SYSTEMIC SCLEROSIS; TOWARDS IDENTIFICATION OF
SPECIFIC PATTERNS**
A. Manfredi, M. Sebastiani, F. Campomori, N. Pipitone, D. Giuggioli, M. Colaci, C. Ferri
- P.217** **ULTRASONOGRAPHIC FEATURES IN THE HAND OF
PATIENTS WITH SYSTEMIC SCLEROSIS REFLECT VISCERAL
MANIFESTATIONS OF THE DISEASE**
G. Coiffier, A. Lescoat, J.D. Albert, C. Droitcourt, C. Cazalets, P. Jego, A. Perdriger
- P.218** **ULNAR ARTERY OCCLUSION ASSESSED BY POWER
DOPPLER ULTRASONOGRAPHY IS ASSOCIATED WITH ACRO-
OSTEOLYSIS IN SYSTEMIC SCLEROSIS**
A. Lescoat, G. Coiffier, J.D. Albert, C. Droitcourt, C. Cazalets, A. Perdriger, P. Jego
- P.219** **RELIABILITY OF THE QUANTITATIVE ASSESSMENT OF
PERIPHERAL BLOOD PERFUSION BY LASER SPECKLE
CONTRAST ANALYSIS IN A SYSTEMIC SCLEROSIS COHORT**
V. Lambrecht, M. Cutolo, F. De Keyser, S. Decuman, B. Ruaro, A. Sulli, E. Deschepper, V. Smith
- P.220** **TRANSITIONAL CHANGES IN THE INTERSTITIAL LUNG
DISEASE USING HIGH RESOLUTION COMPUTED TOMOGRAPHY**
G. Kim, J. Goldin, M. Brown, P. Lo, P. Lu, D. Tashkin
- P.221** **INVOLVEMENT OF JOINT AND TENDON IN SYSTEMIC
SCLEROSIS**
R. Karalilova, Yu. Peeva, Z. Batalov, P. Selimov, S. Tsvetkova, A. Batalov
- P.222** **IS THERE CORRELATION BETWEEN DERMAL THICKNESS
AND PULMONARY INVOLVEMENT IN EARLY DIFFUSE
SYSTEMIC SCLEROSIS? – THE ROLE OF ULTRASOUND**
R. Karalilova, Yu Peeva, Z. Batalov, P. Selimov, S. Tsvetkova, A. Batalov
- P.223** **CLINICAL APPLICATIONS OF NAILFOLD CAPILLAROSCOPY IN
A GENERAL RHEUMATOLOGY SERVICE**
F. Haji, S. Donnelly, G. McCarthy, C.J. McCarthy

- P.224** **CAPILLAROSCOPY IN DAY-TO-DAY PRACTICE - QUALITATIVE OR SEMIQUANTITATIVE CAPILLAROSCOPIC SCORING FOR SCLERODERMA PATIENTS ?**
L. Groseanu, F. Berghea, A. Balanescu, D. Predeteanu, V. Bojinca, I. Saulescu, D. Opris, A. Borangiu, C. Constantinescu, M.M. Negru, S. Daia-Iliescu, M. Abobului, R. Ionescu
- P.225** **RELATION BETWEEN QUALITATIVE AND SEMIQUANTITATIVE CAPILLAROSCOPIC ASSESSMENT AND DISEASE DURATION IN SYSTEMIC SCLEROSIS**
L. Groseanu, F. Berghea, A. Balanescu, D. Predeteanu, V. Bojinca, I. Saulescu, D. Opris, A. Borangiu, C. Constantinescu, M.M. Negru, S. Daia-Iliescu, M. Abobului, R. Ionescu
- P.226** **MOBILE PHONE PHOTOGRAPHS IN THE OBJECTIVE ASSESSMENT OF RAYNAUD'S PHENOMENON**
G. Dinsdale, Y. Andreu-Cabedo, T. Moore, J. Manning, M.R. Dickinson, C.J. Taylor, A.L. Herrick
- P.227** **LONG-TERM DURATION SYSTEMIC SCLEROSIS - WE NEED A RECLASSIFICATION OF CAPILLAROSCOPY PATTERNS. A MULTICENTER STUDY**
P. Clemente-Coelho, A. Cardoso, A. Castro, C. Resende, M.J. Salvador, G. Terroso, L. Costa, I. Silva, F. Araújo, A. Raposo, M.J. Santos
- P.228** **CAPILLAROSCOPIC PATTERN AND ORGAN INVOLVEMENT IN PATIENTS WITH SYSTEMIC SCLEROSIS**
E. Rezus, A. Burlui, A. Cardoneanu
- P.229** **AN EULAR STUDY GROUP PILOT STUDY ON RELIABILITY OF "SIMPLE" CAPILLAROSCOPIC DEFINITIONS TO DESCRIBE CAPILLARY MORPHOLOGY IN RHEUMATIC DISEASES**
V. Smith, S. Beeckman, A L Herrick, S. Decuman, E. Deschepper, F. De Keyser, O. Distler, I. Foeldvari, F. Ingegnoli, U. Müller-Ladner, V. Riccieri, G. Riemekasten, A. Sulli, A. Voskuyl, M. Cutolo on behalf of the EULAR study group on microcirculation in rheumatic diseases
- P.230** **NAILFOLD VIDEOCAPILLAROSCOPY PATTERNS ASSOCIATED WITH CALCINOSIS AND ACRO-OSTEOLYSIS IN SYSTEMIC SCLEROSIS**
J. Avouac, L. Morardet, M. Sammour, A. Kahan, A. Feydy, Y. Allanore

VASCULAR

- P.231 THE EFFICACY AND SAFETY OF BOSENTAN TREATMENT IN SCLERODERMA PATIENTS WITH DIGITAL ULCERS**
S. Ugurlu, B. Ergezen, S. Baykal, D. Cevirgen
- P.232 NAILFOLD CAPILLARY DILATIONS IN PATIENTS WITH RAYNAUD'S PHENOMENON MIGHT ANTICIPATE THE IDENTIFICATION OF THE EARLY SCLERODERMA CAPILLAROSCOPIC PATTERN: A CASE-CONTROL STUDY**
A. Trombetta, A. Sulli, C. Pizzorni, B. Ruaro, S. Paolino, V. Smith, E. Alessandri, M. Cutolo
- P.233 DIGITAL ULCERS IN SYSTEMIC SCLEROSIS AND THE CUTANEOUS SUBSETS: CLINICAL, IMMUNOLOGICAL, NAILFOLD CAPILLAROSCOPY, AND SURVIVAL DIFFERENCES IN THE SPANISH RESCLE REGISTRY**
C. Tolosa, M.L. Morera, B. Mari, A. Guillén, N. Ortego, M. Rubio, L. Tapiella, M. Rodríguez, A. Marin, Cp. Simeón, On behalf of RESCLE
- P.234 NAILFOLD CAPILLAROSCOPY FINDINGS IN SCLERODERMA PATIENTS – PROGNOSTIC IMPLICATIONS**
L. Teixeira, I. Cordeiro, S. Sousa, A.C. Duarte, J. Canas da Silva, A. Cordeiro, M. José Santos
- P.235 SAFETY AND EFFICACY OF BOSENTAN TREATMENT IN JAPANESE PATIENTS WITH DIGITAL ULCERS ASSOCIATED WITH SYSTEMIC SCLEROSIS**
K.Takehara and Du Clinical Trial Group In Japan
- P.236 INTERPLAY OF OSTEOPROTEGRIN (OPG)/ RECEPTOR ACTIVATOR OF NUCLEAR FACTOR-KB LIGAND (RANKL) MOLECULES AS VASCULAR MARKERS IN SYSTEMIC SCLEROSIS**
Y. Suliman, S. Kafaja, M. Alemam, I. Valera, N. Jackson, D. Elashoff, E. Alkady, E. Mosad, E. Moussa, N. Fathi, S. Shapiro, P. Clements, J. Fitzgerald, R. Singh, D. Furst
- P.237 SYSTEMIC SCLEROSIS: ABOUT A PROSPECTIVE SERIES OF 60 PATIENTS**
D. Si Ahmed, F. Haddoum, M. Bouali -Benhalima, F. Bouali
- P.238 CLINICO-HISTOPATHOLOGIC SURVEY OF THE PATIENTS WITH SCLERODERMA-LIKE DISORDER: CASES REVIEW**
H. Seo, E. Kwon, M. Cho, S. Lee, J. Kim
- P.239 SYSTEMIC SCLEROSIS-LIKE NAILFOLD VIDEOCAPILLAROSCOPY CHANGES IN GENETIC MYOPATHIES**
F. Seguro Paula, I.A. Ferreira, M.C. Amaral, A. Valverde, J. Delgado Alves
- P.240 AN ECHOCOLOR-DOPPLER STUDY IN SYSTEMIC SCLEROSIS: ARE SYNTHETIC ANALOGUES OF PROSTACYCLIN PROTECTIVE FOR ENDOTHELIAL DYSFUNCTION OF LARGE VESSELS?**
I. Sciarra, M. Caucci, K. Stefanantoni, M. Vasile, N. Iannace, A. Scarno, G. Valesini, V. Riccieri
- P.241 CAROTID DOPPLER ULTRASOUND AS SCREENING FOR CARDIOVASCULAR RISK IN PATIENTS WITH SYSTEMIC SCLEROSIS**
I. Sanz Pérez, F. Martínez Valle, C.P. Simeon, A. Guillén Del Castillo, E. García-Vives, E. Callejas Moragas, N. Prizi, V. Fonollosa, J. Ordi-Ros, M. Vilardell-Tarrés
- P.242 DEVELOPMENT OF THE MAWDSLEY CALCINOSIS QUESTIONNAIRE (MCQ) VERSION 1 - A PATIENT-REPORTED OUTCOME MEASURE (PROM) FOR SYSTEMIC SCLEROSIS RELATED CALCINOSIS (SSC-CA)**
L. Saketkoo, K. Fligelstone, E. Busman, A. Christensn, S. Khaliq, S. Cenac, A. Aubin, A. Mawdsley, J. Gordon, R. Kaufman, M. Baron, V. Steen, T. Frech
- P.243 EVALUATION OF SKIN BLOOD PERFUSION BY LASER SPECKLE CONTRAST ANALYSIS IN PRIMARY RAYNAUD'S PHENOMENON AND SYSTEMIC SCLEROSIS PATIENTS**
B. Ruaro, A. Sulli, V. Smith, A.C. Trombetta, S. Paolino, C. Pizzorni, M. Cutolo
- P.244 CAN ALTERED HEMORHEOLOGY CONTRIBUTE TO MICROVASCULAR DAMAGE IN SYSTEMIC SCLEROSIS?**
M. Rodrigues, C. Costa, D. Jesus, M. Santiago, P. Carvalho, J. Ferreira, M. Marques, A. Malcata, J.A.P. da Silva, M.J. Salvador
- P.245 AN INTERNAL MEDICINE DEPARTMENT 'S EXPERIENCE WITH ILOPROST**
R. Ribeiro, M. Silva, J. Oliveira, P. Barreto, S. Pinheiro
- P.246 IMMEDIATE IMPROVEMENTS IN HAND PUFFINESS & MOBILITY IN SCLERODERMA FOLLOWING ILOPROST INFUSIONS**
C. Rajapakse
- P.247 EFFECT OF BOSENTAN ON THE MICROCIRCULATION CAPILLARY FLOW IN PATIENTS WITH SYSTEMIC SCLEROSIS AND DIGITAL ULCERS: CAPILLAROSCOPIC ANALYSIS OF 6 PATIENTS**
F. Ortiz Sanjuán, C. Alcañiz Escandell, K. Arévalo Ruales, I. Chalmeta Verdejo, C. Fedec Olmos, J. Frago Gil, L. González Puig, E. Labrador Sánchez, I. Martínez Cordellat, R. Negueroles Albuixech, J. L. Valero Sanz, E. Grau García, J. Ivorra Cortés, C. Núñez-Cornejo Piquer, J. A. Román Ivorra

- P.248 SYSTEMIC SCLEROSIS AND THE VASOREACTIVITY OF CEREBRAL MICROCIRCULATION**
E. Morgiel, M. Nowakowska-Kotas, M. Madej, R. Podemski, P. Wiland
- P.249 ANTIHOSPHOLIPID ANTIBODIES IN A COHORT OF PATIENTS WITH SYSTEMIC SCLEROSIS – A CROSS-SECTIONAL CLINICAL STUDY**
T. Meirinhos, R. Fonseca, D. Gonçalves, F. Aguiar, T. Martins-Rocha, L. Costa
- P.250 PREDICTIVE VALUE OF ALLEN TEST FOR THE OCCURENCE OF NEW DIGITAL ULCER IN SSC-PATIENTS**
R. Cimino, C. Pintadi, S. Mazzuca
- P.251 OUTCOME AND MANAGEMENT OF SSC-PATIENTS WITH DIGITAL ULCERS (DU) IN A SINGLE CENTRE (N° 334) OF DUO REGISTRY.**
C. Pintaudi, R. Cimino, S. Mazzuca
- P.252 BONE MARROW-DERIVED MESENCHYMAL STEM CELLS (MSC) FROM SYSTEMIC SCLEROSIS (SSC) EXPRESS LOW LEVELS OF CD13: A POSSIBLE EXPLANATION FOR IMPAIRED ABILITY TO DIFFERENTIATE TOWARD THE ENDOTHELIAL LINEAGE?**
C. Mazzotta, M. Manetti, E. Romano, I. Rosa, L. Ibba-Manneschi, S. Bellando-Randone, S. Guiducci, M. Matucci-Cerinic
- P.253 INFRARED THERMOGRAPHY AFTER COLD CHALLENGE: VALIDATION IN DIAGNOSIS OF RAYNAUD’S PHENOMENON IN PEDIATRIC AGE**
G. Martini, M. Cappella, R. Culpò, M. Sprocati, A. Meneghel, F. Zulian
- P.254 SCLERODERMA WITH PSEUDOAINHUM**
M. Marques Silva, R. Ribeiro, J. Oliveira
- P.255 VASCULAR EVALUATION OF THE HAND BY POWER DOPPLER ULTRASONOGRAPHY PROVIDES NEW PREDICTIVE MARKERS OF ISCHEMIC DIGITAL ULCERS IN SYSTEMIC SCLEROSIS.**
A. Lescoat, G. Coiffier, A. Rouil, C. Droitcourt, C. Cazalets, A. Perdriger, P. Jégo
- P.256 PERIPHERAL VASOCONSTRICTION INDUCED BY BETA-BLOCKERS: A SYSTEMATIC REVIEW AND A NETWORK META-ANALYSIS.**
C. Khouri, T. Jouve, S. Blaise, P. Carpentier, J.L. Cracowski, M. Roustit
- P.257 SEASONAL VARIATION OF RAYNAUD’S PHENOMENON AND DIGITAL ULCERS IN SYSTEMIC SCLEROSIS: A MULTICENTER LONGITUDINAL STUDY**
C. Kayser, J.E.R. Souza, C.S. Muller, A.T. Dantas, H.A. Mariz, A.M.C. Horimoto, R.A. Rezende, I. Guimarães, I.P. Costa, G.R.L. Bertazzi, L. Paiola, E. Freire, R. Ismael, A.P.T. Del-Rio, J. Sekiyama, C.B. Kawhage
- P.258 COMPARISON OF ULNAR ARTERY VASCULOPATHY IN CONNECTIVE TISSUE DISEASES**
J. Jun, T. Kim, S. Song, H. Ahn, S. Bae, Y. Sung
- P.259 DEEP VEIN THROMBOSIS AND PULMONARY EMBOLISM IN SYSTEMIC SCLEROSIS**
N. Hakami, S. Johnson
- P.260 CONTRIBUTION OF NAILFOLD VIDEOCAPILLAROSCOPY TO THE DIAGNOSIS OF SYSTEMIC SCLEROSIS IN THE JAPANESE POPULATION**
Y. Ichimura, Y. Kawaguchi, K. Takagi, A. Tochimoto, T. Higuchi, Y. Katsumata, H. Yamanaka
- P.261 DIGITAL ULCERS IN SYSTEMIC SCLEROSIS ARE ASSOCIATED WITH MICROANGIOPATHIC ABNORMALITIES OF PERI-LESIONAL SKIN AS ASSESSED BY CAPILLAROSCOPY**
M. Hughes, T. Moore, J. Manning, G. Dinsdale, A. Murray, A. Herrick
- P.262 THERMOGRAPHIC ABNORMALITIES PREDICT FUTURE DIGITAL ULCERS AND DEATH IN PATIENTS WITH SYSTEMIC SCLEROSIS**
M. Hughes, J. Wilkinson, T. Moore, J. Manning, P. New, G. Dinsdale, A. Murray, A. Herrick
- P.263 CRITICAL DIGITAL ISCHAEMIA IN SYSTEMIC SCLEROSIS: THE IMPORTANCE OF REMEMBERING THERE IS A DIFFERENTIAL DIAGNOSIS**
C.A Sharp, Q. Akram, M. Hughes, L. Muir, A.L. Herrick
- P.264 NON-INVASIVE OXYGEN-OZONE THERAPY IN THE TREATMENT OF DIGITAL ULCERS IN PATIENTS WITH SYSTEMIC SCLEROSIS**
M. Hassanien, S. Rashad, A. Algohe, A. Awamy, N. Mohamed
- P.265 CENTRAL NERVOUS SYSTEM INVOLVEMENT IN SYSTEMIC SCLEROSIS**
F. Ajili, N. Guediche, M. Lajmi, N. Boussetta, S. Sayhi, L. Metoui, I. Gharsallah, N. Ben Abdelhafidh, B. Louzir, S. Othmani
- P.266 SYSTEMIC SCLEROSIS ASSOCIATED TO ESSENTIAL THROMBOCYTHEMIA CAUSING SEVERE DIGITAL ISCHEMIA**
F. Ajili, N. Guediche, M. Lajmi, N. Boussetta, S. Sayhi, L. Metoui, I. Gharsallah, N. Ben Abdelhafidh, B. Louzir, S. Othmani
- P.267 A PILOT STUDY ON SOLUBLE (PRO)RENIN RECEPTOR IN PATIENTS WITH SYSTEMIC SCLEROSIS**
M. Gorga, A.M. Soare, A.M. Gherge, R. Dobrota, C. Mambet, C. Mihai
- P.268 DIGITAL ULCER SCORE - A SCORING SYSTEM TO ASSESS DIGITAL ULCERS IN PATIENTS SUFFERING FROM SYSTEMIC SCLEROSIS**
H. Gil, E. Siegert, D. Tornsitz, K. Mattat, C. March, G. Riernekasten, M. Worm

- P.269 CORRELATION BETWEEN NAILFOLD MICROANGIOPATHY SEVERITY AND MACROVASCULAR DISEASE IN SYSTEMIC SCLEROSIS PATIENTS**
G. Eugénio, A. Daniel, J.F. Ferreira, J. Rovisco, S. Serra, C. Costa, M. Rodrigues, C. Duarte, A. Malcata, M.J. Salvador
- P.270 THE INFLUENCE OF IMMUNOSUPPRESSIVE THERAPY ON MICROANGIOPATHY IN SYSTEMIC SCLEROSIS AS MEASURED WITH NAILFOLD CAPILLAROSCOPY**
J. Meijs, B. de Boer, A.A. Schouffoer, T.W.J. Huizinga, H. Putter, J.K. de Vries-Bouwstra
- P.271 INTIMA-MEDIA THICKNESS EVALUATION AND CARDIOVASCULAR RISK ESTIMATION IN A COHORT OF SYSTEMIC SCLEROSIS PATIENTS**
A. Daniel, G. Eugénio, J. Ferreira, S. Serra, J. Rovisco, C. Costa, M. Rodrigues, M. Santiago, A. Malcata, J. António Pereira da Silva, M. João Salvador
- P.272 TREPROSTINIL IONTOPHORESIS IMPROVES DIGITAL BLOOD FLOW DURING LOCAL COOLING IN SYSTEMIC SCLEROSIS**
J. Cracowski, F. Gaillard-Bigot, S. Blaise, C. Cracowski, C. Seinturier, B. Imbert, P. Carpentier, M. Roustit
- P.273 OLIGOSYMPTOMATIC PULMONARY EMBOLISM IN SYSTEMIC SCLEROSIS PATIENTS**
I. Cordeiro, A. Cordeiro, T. Judas Matos, M. Loureiro, V. Martins, S. Carmona, J. Canas Da Silva, M. Santos
- P.274 MICROVASCULATURE CHANGES AND ANGIOGENIC FACTORS IN SYSTEMIC SCLEROSIS - DATA FROM A SINGLE CENTER REGISTRY**
R. Becvar, S. Skacelova, J. Stork, H. Hulejova, I. Putova, M. Tomcik, M. Jachymova
- P.275 SKIN TELANGIECTASIA IDENTIFY A SUBSET OF SYSTEMIC SCLEROSIS PATIENTS WITH SEVERE VASCULAR DISEASE**
J. Avouac, C. Hurabiel, G. Lepri, T. De Risi, A. Kahan, Y. Allanore
- P.276 ABNORMAL LIPID PROFILE AS A RISK FACTOR FOR ATHEROSCLEROSIS IN SYSTEMIC SCLEROSIS: RESULTS FROM A MULTICENTRIC EUSTAR COHORT**
C. Ancuta, C. Belibou, C. Pomirleanu, C. Mihai, P. Carreira, J.L. Rosales Alexander, J.J. Alegre, V. Riccieri, M.J. Salvador, R. Chiriac
- P.277 MICROVASCULAR ANGINA IN SYSTEMIC SCLEROSIS**
I. Aleksic, B. Stamenkovic, M. Deljanin Ilic, S. Milenkovic
- P.278 JUVENILE-ONSET SYSTEMIC SCLEROSIS WITH SEVERE VASCULAR LESIONS AND MILD EVIDENCE OF ORGAN-SPECIFIC INVOLVEMENT: A CASE REPORT**
S. Agachi, L. Groppa, S. Popa, I. Pirlog
- P.279 HEALING OF DIGITAL ULCERS IN SYSTEMIC SCLEROSIS: REAL LIFE DATA FROM THE DESSCIPHER OBSERVATIONAL STUDY OF THE EUSTAR GROUP**
G. Abignano, J. Blagojevic, Y. Allanore, J. Avouac, L. Czirják, C. Denton, O. Distler, M. Frerix, D. Huscher, V.K. Jaeger, V. Lóránd, B. Maurer, U. Müller-Ladner, S. Nihtyanova, G. Riemekasten, E. Siegert, S. Vettori, U.A Walker, L. Cometi, S. Guiducci, M. Matucci-Cerinic, F. Del Galdo
- P.280 MULTICENTER OBSERVATIONAL STUDY OF THE REPERCUSSIONS OF DIGITAL ULCERS ON FUNCTIONAL DISABILITY AND WORK AND DAILY ACTIVITIES IN PATIENTS WITH SYSTEMIC SCLEROSIS: LAUDES STUDY**
I. Castellví, S. Eguiluz, V. Fonollosa, J. A. Román, M. Alirangues

RENAL

- P.281 A RETROSPECTIVE CLINICAL ANALYSIS OF 25 CHINESE PATIENTS WITH SCLERODERMA RENAL CRISIS FROM A SINGLE CENTER**
J. Zhou, D. Xu, Y. Hou, X. Zeng
- P.282 CLINICAL FEATURES AND NEPHROPATHY RISK IN PATIENTS WITH SYSTEMIC SCLEROSIS (BASED ON 5-YEAR FOLLOW-UP)**
O. Sirenko, O. Kuryata, V. Semenov, T. Lusynets
- P.283 NON-INVASIVE BIOMARKERS OF ASSESSMENT OF KIDNEY AND LIVER FIBROSIS**
A. Siebuhr, P. Juhl, M.J. Nielsen, M.A. Karsdal, J.S. Neergaard, K. Dragsbæk, C. Christiansen, F. Genovese, D.J. Leeming, M. Papisotiriou, J. Floege, P. Boor, D. Schuppan, A.C. Bay-Jensen
- P.284 RENAL MANIFESTATIONS IN SYSTEMIC SCLERODERMA**
D. Si Ahmed, F. Haddoum, H. Arzour, M. Bouali-Benhalima, K. Kalem, F. Bouali

- P.285** **MANIFESTATIONS OF SYSTEMIC SCLEROSIS IN PATIENTS WITH DIFFERENT INITIAL RENAL STATUS**
V. Semenov, T. Lysunets, O. Kuryata
- P.286** **RISK FACTORS ASSOCIATED WITH DECREASED GLOMERULAR FILTRATION RATE IN SYSTEMIC SCLEROSIS**
P. Ostojic, N. Stojanovski, N. Damjanov
- P.287** **ACUTE KIDNEY INJURY IN A SYSTEMIC SCLEROSIS PATIENT**
S. Puksic, A. Sutic, J. Morovic-Vergles
- P.288** **SCLERODERMA RÉNAL CRISIS . ABOUT ONE CASE**
O. Mkinsi
- P.289** **EXPOSURE TO ACE INHIBITORS PRIOR TO ONSET OF SCLERODERMA RENAL CRISIS IS NOT ASSOCIATED WITH INCREASED RISK OF MORTALITY IN A LARGE RETROSPECTIVE COHORT STUDY**
S. R. Johnson, M. Elarabi, S. Proudman, T. Frech, J. Sahhar, W. Stevens, J. Zochling, Z. Ahmad, Canadian Scleroderma Research Group, M. Baron, M. Hudson

MUSCULOSKELETAL SYSTEM & REHABILITATION

- P.290** **DETECTION OF ANTINUCLEAR ANTIBODIES BY INDIRECT IMMUNOFUORESCENCE AND A COMPARISON OF THEM TO ANTI-SCL-70 AND ANTI-ENA ANTIBODIES DETECTED USING ELISA IN PATIENTS SUFFERING FROM SYSTEMIC SCLERODERM**
N. Zotos, M. Gianniki, I. Tatsina, T. Potsis, A. Papadopoulou, D. Bougias, C. Georgiou, E. Chrisostomou, A. Pournou, N. Tsifetaki
- P.291** **THE PREVALENCE AND SIGNIFICANCE OF ANTI-PM/SCL ANTIBODIES IN SYSTEMIC SCLEROSIS**
E. Wielosz, M. Majdan, M. Dryglewska
- P.292** **PREVALENCE AND PREDICTORS OF HAND INVOLVEMENTS IN THAI PATIENTS WITH SYSTEMIC SCLEROSIS**
S. Wangkaew, C. Sivasomboon, W. Leungwattananon, N. Kasitanon, W. Louthrenoo
- P.293** **EXTENSIVE PHYSICAL THERAPY FOR THE TREATMENT OF HAND FUNCTION IMPAIRMENT IN PATIENTS WITH SYSTEMIC SCLEROSIS**
C. Varjú, J. Horváth, Z. Bálint, E. Szép, A. Deiszinger, R. Páhyne Takács, T. Minier, N. Farkas, E. Török, A. Dézsi, F. Vida, É. Horváthné Papp, D. Komjáti, Z. Mándó, L. Czirják
- P.294** **CAVEOLIN-1 REVERSED EFFECT OF PROFIBROTIC CYTOKINES ON MONOCYTES TO ADIPOCYTES DIFFERENTIATION**
E. Tourkina, C. Reese, G. Carmen-Lopez, R. Lee, M. Bonner, M. Zemskova, RM. Silver, S. Hoffman
- P.295** **TUMORAL CALCINOSIS IN SYSTEMIC SCLEROSIS: FOUR NEW CASES AND REVIEW OF THE LITERATURE**
E. Toniolo, J. Avouac, I. Castellví, J. Narváez, Y. Allanore
- P.296** **CLINICAL UTILITY OF SALT & PEPPER SKIN IN DIFFUSE SYSTEMIC SCLEROSIS**
K. Solanki, C. Hor, W.S.J. Chang, D.H.N. White
- P.297** **PREVALENCE OF OTHER AUTOIMMUNE DISEASES IN PATIENTS WITH SYSTEMIC SCLEROSIS - A SINGLE CENTER STUDY**
S. Pintilie, A. Soare, A.M. Gherge, R. Dobrota, M. Gorga, A. Radu, R. Oneata, S. Magda, T. Constantinescu, R. Jurcut, M. Sasu, L. Macovei, M. Milicescu, I. Ancuta, V. Stoica, M. Bojinca, C. Mihai
- P.298** **FOOT PAIN AND LESIONS IN SYSTEMIC SCLEROSIS; IS THERE ANY ASSOCIATION WITH ORGAN INVOLVEMNET?**
S. Poormoghim, E. Andalib, A. Jalali, A. Almasi
- P.299** **USE OF ADAPTIVE STRATEGIES BY PERSONS WITH SYSTEMIC SCLEROSIS TO PERFORM DAILY ACTIVITIES**
J. Poole, V. Stofer
- P.300** **FEASIBILITY OF SUBMAXIMAL EXERCISE TESTS IN PATIENTS WITH SYSTEMIC SCLEROSIS IN A CLINICAL SETTING**
H. Pettersson, H. Alexanderson, E. Svenungsson, A. Nordin, C. Boström
- P.301** **LONG-TERM EFFICACY OF SELF-ADMINISTRATED STRETCHING FOR FINGER FUNCTION IN JAPANESE PATIENTS WITH SYSTEMIC SCLEROSIS**
N. Mugii, Y. Hamaguchi, S. Oohata, T. Matsushita, K. Takehara
- P.302** **REHABILITATION IN SYSTEMIC SCLEROSIS BY VOCAL INTERVENTION: FROM CASE TO CONCEPT?**
M. Mickel, T. Stegemann, R. Crevenna

- P.303 THE EFFECT OF PARAFFIN BATH PRIOR TO HAND EXERCISES FOR PATIENTS WITH SYSTEMIC SCLEROSIS**
L. Qvist Kristensen, L. Gregersen Oestergaard, K. Bovbjerg, K. Soendergarrd
- P.304 HANDS ON – A HAND CARE GUIDE IN SYSTEMIC SCLEROSIS**
S. Landim, M. F. Marcatto de Abreu, C. C. Leme Mazon, C. Ferreira Bernardes, A. P. Toledo Del Rio, J. F. Marques-Neto, M. Barros Bertolo, E. de Paiva Magalhães
- P.305 ANTI-HETEROGENOUS NUCLEAR RIBONUCLEOPROTEIN (ANTI- HNRNP) AND OTHER AUTOANTIBODIES IN SYSTEMIC SCLEROSIS WITH JOINT INVOLVEMENT IN COMPARISON BY JOINT X- RAY**
N. Fathi, N. Ismail, S. Goma, A. M. Ghandour, S. Hussein, E. Mosad
- P.306 OSTEOPOROSIS IN A HUNGARIAN SCLERODERMA PATIENT'S COHORT**
Á Horváth, G. Szucs, S. Szamosi
- P.307 A NEW OVERLAP SYNDROME: SYSTEMIC LUPUS ERYTHEMATOSUS AND SCLEROMYOSITIS: A CASE REPORT**
Z. Hadj Ali, S. Sayhi, N. Bousetta, F. Agili, I. Gharsallah, L. Metoui, R. Battikh, B. Louzir, N. Abd Elhafidh, S. Othmani
- P.308 SCLEROMYOSITIS: ABOUT 2 CASES**
F.Agili, Z.Hadj Ali, S.Sayhi, N.Bousetta, I Gharsallah, L.Metoui, N.Abd Elhafidh, R.Battikh, B.Louzir, S.Othmani
- P.309 MORPHEA IN A ZOSTERIFORM DISTRIBUTION- A RARE CLINICAL ENTITY**
L. Groseanu, T. Gudu, R. Ionescu
- P.310 WAX BATHS DO NOT MAKE HAND EXERCISES MORE EFFECTIVE IN PEOPLE WITH SYSTEMIC SCLEROSIS: A RANDOMISED CONTROLLED TRIAL.**
W.J. Gregory, P.R. Briffa, K.L. Young, J. Wilkinson, A.L. Herrick
- P.311 DISSECTING THE ROLE OF SIGNAL TRANSDUCER AND ACTIVATOR OF TRANSCRIPTION 3 (STAT-3) IN SYSTEMIC SCLEROSIS**
G. Febriana, S. O'Reilly, J.M. Van Laar
- P.312 PREVALENCE AND PREDICTORS OF DIGITAL ULCERS IN A COHORT OF SYSTEMIC SCLEROSIS**
C. Costa, M. Rodrigues, M. Santiago, D. Jesus, P. Carvalho, M. Marques, A. Daniel, G. Eugénio, J. Ferreira, J. Silva, A. Malcata, J.A.P. Silva, M.J. Salvador
- P.313 EFFECT OF RESPIRATORY MUSCLE TRAINING ON EXERCISE PERFORMANCE IN SYSTEMIC SCLEROSIS. A PILOT STUDY**
M. Buslau, St. Vogt, Th. Ettlín
- P.314 SYSTEMIC SCLEROSIS AND OSTEOPOROSIS**
P. Athanassiou, A. Tzanavari, T. Banti, C. Katsavouni, A. Spyridis, I.Kostoglou-Athanassiou
- P.315 MAGNETIC RESONANCE IMAGING OF SACROILIAC JOINTS IN SYSTEMIC SCLEROSIS PATIENTS**
D. Arslan Tas, I. Turk, O. Kudas, B. Kelle, H. Sakalli
- P.316 THE RELEVANCE OF MODERN IMAGING FOR THE DIAGNOSIS OF OROFACIAL PATHOLOGY IN SYSTEMIC SCLEROSIS: A CASE REPORT OF MANDIBULAR CONDYLAR RESORPTION**
C. Ancuta, C. Iordache, M. Antohe
- P.317 BONE MINERAL DENSITY AND FRACTURE RISK IN AN EUSTAR COHORT OF PATIENTS WITH SYSTEMIC SCLEROSIS**
C. Ancuta, C. Belibou, R. Maxim, C. Pomirleanu, R. Chirieac
- P.318 SUBCUTANEOUS CALCINOSIS IN PATIENTS WITH SYSTEMIC SCLEROSIS**
A. Abdessemed, N. Khaldoun, A. Djoudi, R. Chetouane, S. Haid , N. Brahimi , A. Ladjouze

GASTROINTESTINAL / NUTRITION

- P.319 GASTROINTESTINAL INVOLVEMENT IN PATIENTS WITH SYSTEMIC SCLEROSIS: CASE STUDY OF A RHEUMATOLOGY UNIT**
J. Sousa Neves, A. Raposo, M. Cerqueira, D. Santos Faria, F. Teixeira, J. Costa, M. Afonso
- P.320 PRIMARY BILIARY CIRRHOSIS DURING THE SCLERODERMA SYSTEMIC**
D. Si Ahmed, F. Haddoum, M. Bouali-Benhalima, F. Bouali
- P.321 PHARYNGO OESOPHAGEAL DYSPHAGIA IN SCLERODERMA – AN UNDER RECOGNISED, POTENTIALLY FATAL BUT TREATABLE PHENOMENON**
C. Rajapakse
- P.322 SOCIAL AND PSYCHOLOGICAL IMPACT OF GASTROINTESTINAL INVOLVEMENT IN SSC – ROMANIAN SURVEY**
A. Petcu, I.R Dobrota, S. Rednic

- P.323 REYNOLDS SYNDROME – THE COEXISTENCE OF TWO RARE AUTOIMMUNE DISEASES**
P. Monteiro, R. Fernandes, M. Moreira, C. Silva, P. Ferreira, C. Coelho, A. Seixas, V. Paixão Dias
- P.324 FECAL INCONTINENCE AND ASSOCIATION WITH BOWEL DYSFUNCTION IN SYSTEMIC SCLEROSIS: A CANADIAN MULTICENTER STUDY**
R. Nicholas, M. Hudson, G. Gyger, M. Baron, N. Khalidi, M. Larche, P. Fortin, J. Pope, K. Thorne, E. Sutton, N. Carrier, A. Masetto
- P.325 FRUCTOSE MALABSORPTION IN SYSTEMIC SCLEROSIS**
I. Marie
- P.326 EOSINOPHILIC FASCIITIS AS A PARANEOPLASTIC MANIFESTATION: CASE REPORT AND REVIEW OF THE LITERATURE**
C. Manzini, G. Cassone, C. Vacchi, M. Colaci, M. Sebastiani, E. Cocchiara, C. Ferri
- P.327 ABNORMAL VITAMIN-D LEVELS AND GASTROINTESTINAL (GI) MANIFESTATIONS IN SYSTEMIC SCLEROSIS (SSC)**
A. Aly, Y. Suliman, Y. Shaweesh, M. Alemam, I. Valera, S. Vangala, D. Elahoff, P. Clements, D. Furst, S. Kafaja
- P.328 IMPACT OF PROKINETIC AGENTS ON SYSTEMIC SCLEROSIS-ASSOCIATED GASTROINTESTINAL DISEASE: A SYSTEMATIC REVIEW**
A. Tisseverasinghe, A. Kadhim, A. Parmar, L. Liu, S. Johnson
- P.329 SEVERITY OF GASTROINTESTINAL SYMPTOMS IN THE PROSPECTIVE REGISTRY OF EARLY SYSTEMIC SCLEROSIS (PRESS) COHORT.**
T. Frech, M. Murtaugh, J. Gordon, R. Domsic, A. Shah, F. Hant, S. Assassi, M. Hinchcliff, E. Bernstein, V. Steen, V. Shanmugam, D. Khanna
- P.330 ASSESSMENT OF SUBLINGUAL FRENULUM PERFUSION IN SYSTEMIC SCLEROSIS**
T. Frech, D. Machin, P. Gates, R. Domsic, L. Shapiro, J. Pauling, H. Vink, E. Frech, A. Donato
- P.331 EFFECTIVENESS OF ADD-ON THERAPY WITH DOMPERIDONE VS. ALGINIC ACID IN PROTON PUMP INHIBITOR PARTIAL RESPONSE GASTROESOPHAGEAL REFLUX DISEASE IN SYSTEMIC SCLEROSIS: RANDOMIZED PLACEBO CONTROLLED TRIAL**
C. Foocharoen, K. Chunlertrith, P. Mairiang, A. Mahakkanukrauh, S. Suwannaroj, S. Namvijit, O. Wantha, R. Nanagara
- P.332 NUTRITIONAL ASSESSMENT IN A COHORT OF PATIENTS WITH SCLERODERMA**
M. Cusa, M.F. Cusa, S. Scarafia, M.A Lazaro
- P.333 ETIOLOGICAL PROFILE OF DIGESTIVE AFFECTION IN DIFFUSE SYSTEMIC SCLEROSIS AND CREST SYNDROME:STUDY OF 32 PATIENTS.**
G. Chalhoub, G. Brabant, M.L. Scherrer, B. Benet, P. Okamba, M. Valla
- P.334 GASTRIC ANTRAL VASCULAR ECTASIA IN SYSTEMIC SCLEROSIS PATIENTS: LONG-TERM PROGNOSIS AND TREATMENT**
Y. Braun-Moscovici, M. Braun, I. Hermesh, Y. Tavor, M. Nafaa, R. Beshara-Garzoz, D. Markovits, K. Toledano, A. Rozin, A. Balbir Gurman
- P.335 PERSISTENT REFLUX ESOPHAGITIS EVALUATED BY ESOPHAGOGASTRODUODENOSCOPY IN THE PATIENTS WITH SYSTEMIC SCLEROSIS**
H. Baek, H. Ryu, M. Seo, H. Choi
- P.336 GASTROINTESTINAL INVOLVEMENT IN SYSTEMIC SCLEROSIS: A COMMON AND SERIOUS FEATURE OF THE DISEASE**
F. Aguiar, T. Martins-Rocha, T. Meirinhos, D. Rosa-Gonçalves, R. Fonseca, I. Brito, L. Costa
- P.337 ESOPHAGEAL DILATION AND HEALTH-RELATED QUALITY OF LIFE IN SYSTEMIC SCLEROSIS**
M. Blanco, M. Ma, J. Lee, R. Agrawal, R. W. Chang, M. Hinchcliff

PREGNANCY & GENDER RELATED ISSUES

- P.338 SYSTEMIC SCLEROSIS IN A COHORT OF MEN**
D. Si Ahmed, H. Haddoum, M. Bouali -Benhalima, F. Bouali
- P.339 EXPOSURE TO BOSENTAN IN EARLY PREGNANCY: A CASE REPORT**
V. Ramoni, M. Betelli, G. Grosso, S. Rampello, M.L. Farina, G. Contessa, G. Bacis, M. Limonta, A. Brucato
- P.340 JUVENIL LOCALIZED SCLERODERMA OR LICHEN SCLEROSIS OF ANOGENITAL AREA?**
M. Osminina, N. Geppe, V. Volnukhin, J. Kostina, O. Shpionkova
- P.341 PREGNANCY IMPROVES MICROCIRCULATION IN SSC PATIENTS. CAPILLAROSCOPIC STUDY**
C. Pintaudi, R. Cimino, S. Mazzuca
- P.342 FERTILITY AND PREGNANCY IN SYSTEMIC SCLEROSIS – A EUSTAR CENTER EXPERIENCE**
L. Groseanu, A. Peltea, A. Balanescu, V. Bojinca, I. Saulescu, D. Opris, A. Borangiu, C. Constantinescu, M.M. Negru, S. Daia-iliescu, F. Berghea, D.Predeteanu, M. Abobului, V. Vlad, R. Ionescu
- P.343 CLINIC AND MORTALITY DIFFERENCES BETWEEN SCLERODERMIC MEN AND WOMEN OF THE RESCLE COHORT**
M. Freire, C.P. Simeón Aznar, A. Rivera Gallego, A. Soto Peleteiro, B. Mari Alfonso, D. Colunga Argüelles, J.A. Todolí Parra, X. Pla Salas, M. Ruiz Muñoz, V. Fonollosa Pla, On behalf of RESCLE Group
- P.344 RATES AND CORRELATES OF SEXUAL DYSFUNCTION IN SYSTEMIC SCLEROSIS AND LUPUS PATIENTS: A CASE-CONTROLLED STUDY**
M. Coutinho, G. Eugénio, M. Rodrigues, F. Costa, C. Duarte, T. Santiago, T. Dias, V. Silva, I. Ruela, L. Inês, M.J. Salvador, J.A.P. Da Silva

RECENT ADVANCES IN THERAPY

- P.345 WITHDRAWN**
- P.346 LONGITUDINAL ANALYSIS OF MMF CLINICAL AND MOLECULAR RESPONSES SHOW SSC PATIENTS LOSE THEIR INFLAMMATORY SIGNATURE AND REBOUND UPON TREATMENT CESSATION**
M. Hinchcliff, J. Taroni, D. Toledo, T. Wood, J. Franks, S. Shav, R. Agrawal, L. Beussink-Nelson, M. Carns, S. Podluszky, M. Whitfield
- P.347 EFFICACY AND SAFETY OF TOCILIZUMAB IN PATIENTS WITH SYSTEMIC SCLEROSIS: EXPERIENCES IN A ROUTINE CLINICAL SETTING**
Y. Shirai, T. Takeuchi, M. Kuwana
- P.348 USE OF RITUXIMAB PLUS CYCLOPHOSPHAMIDE IN SYSTEMIC SCLEROSIS LUNG FIBROSIS**
M. Saracco, R. Vitetta, G. Rovera, R. Pellerito
- P.349 RITUXIMAB IN TREATMENT OF SYSTEMIC SCLEROSIS PATIENTS WITH REFRACTORY MYOPATHY – CASE SERIES**
M. Radic, D. Martinovic Kaliterna, D. Perkovic, D. Marasovic Krstulovic, K. Boric
- P.350 THE EFFICACY OF FOSTAMATINIB THERAPY ON ISCHEMIA-REPERFUSION INJURY IN A BLEOMYCIN-INDUCED SCLERODERMA MOUSE MODEL**
O. Pamuk, G. Can, T. Karaca, S. Ayvaz, S. Demirtas, G. Pamuk, G. Tsokos
- P.351 SUCCESSFUL IMPROVEMENT OF SKIN INVOLVEMENT IN SYSTEMIC SCLEROSIS PATIENT AFTER AUTOLOGOUS HEMATOPOIETIC STEM CELL TRANSPLANTATION: CASE REPORT**
F. Ortiz Sanjuán, C. Alcañiz Escandell, K. Arévalo Ruales, I. Chalmeta Verdejo, C. Fedec Olmos, J. Frago Gil, L. González Puig, E. Labrador Sánchez, I. Martínez Cordellat, R. Negueroles Albuixech, J. L. Valero Sanz, E. Grau Garcia, J. Ivorra Cortès, C. Núñez-Cornejo Piquer, J. A. Román Ivorra

- P.352** **TOCILIZUMAB IN A CASE OF SSC WITH AN UNYIELDING PROGRESSION TO SEVERE FIBROSIS**
J. Oliveira, A. Brasileiro, C. Costa, R. Ribeiro, M. Marques Silva, S. Pinheiro, A. Castro
- P.353** **SINGLE SAMPLE PREDICTOR (SSP) FOR MOLECULAR CLASSIFICATION OF SKIN BIOPSIES OF PATIENTS WITH SYSTEMIC SCLEROSIS - UTILIZING GENE EXPRESSION PROFILING TO GUIDE PATIENT MANAGEMENT**
Y. Nesbeth, K. Archambault, J. Parker, T. Wood, M. Mahoney, S.J. Shah, L. Beussink-Nelson, J.L. Lauren, A. Sirajuddin, M. Carns, S. Podluszky, M. Hinchcliff, M. Whitfield
- P.354** **THERAPEUTIC EFFECT OF MESENCHYMAL STEM CELLS IN A MURINE MODEL OF SYSTEMIC SCLEROSIS**
A. Maria, K. Toupet, C. Bony, N. Pirot, Mc. Vozenin, S. Riviere, A. Le Quellec, C. Jorgensen, D. Noël, P. Guilpain
- P.355** **PRELIMINARY DATA ON USE OF TOCILIZUMAB IN REFRACTORY JUVENILE LOCALISED SCLERODERMA**
H. Lythgoe, E. Baildam, M.W. Beresford, G. Cleary, L.J. McCann, E. Pain
- P.356** **A COMPARATIVE REVIEW OF THE NEW EULAR/EUSTAR AND BRITISH SYSTEMIC SCLEROSIS EVIDENCE BASED TREATMENT RECOMMENDATIONS**
J. Lee, R. Pellar, J. Pope
- P.357** **A CASE REPORT OF A LOCALIZED SCLERODERMA IMPROVED BY COLCHICINE**
F. Ajili, M. Lajmi, N. Guedich, N. Bousetta, R. Dhahri, L. Metoui, B. Louzir, I. Garsallah, S. Othmeni
- P.358** **PRECISION MEDICINE FOR PATIENTS WITH SYSTEMIC SCLEROSIS**
K. Komura, J. Varga
- P.359** **EFFICACY AND SAFETY OF MYCOPHENOLATE MOFETIL (MMF) VERSUS ORAL CYCLOPHOSPHAMIDE (CYC) FOR TREATMENT OF SCLERODERMA-INTERSTITIAL LUNG DISEASE (SSC-ILD): RESULTS OF SCLERODERMA LUNG STUDY II**
D. Khanna, M. Roth, R. Elashoff, D. Furst, P. Clements, C. Tseng, D. Tashkin
- P.360** **PRELIMINARY SAFETY AND EFFICACY DATA FROM THE ONGOING FASCINATE TRIAL OF SUBCUTANEOUS TOCILIZUMAB IN ADULTS WITH SYSTEMIC SCLEROSIS**
D. Khanna, C.P. Denton, J.M. van Laar, A. Jahreis, S.H. Spotswood, J. Siegel, D.E. Furst
- P.361** **NARROW BAND – 365 NM ULTRAVIOLET A1 LIGHT THERAPY IN BLEOMYCIN-INDUCED SCLERODERMA ANIMAL MODEL**
D. Karpec, R. Rudys, Z. Mackiewicz, L. Leonaviciene, R. Bradunaite, R. Ruginiene, G. Kirdaite, A. Venalis
- P.362** **ANTI-FIBROTIC POTENTIAL OF CPA ON DERMAL FIBROBLASTS IN SYSTEMIC SCLEROSIS**
T. Higuchi, Y. Kawaguchi, K. Takagi, A. Tochimoto, Y. Ichimura, H. Yamanaka, K. Okada
- P.363** **ANALYSIS OF HUMORAL IMMUNE RECONSTITUTION AFTER AUTOLOGOUS STEM CELL TRANSPLANTATION FOR SYSTEMIC SCLEROSIS: MOLECULAR RECOGNITION PATTERNS OF ANTI-TOPO-ISOMERASE I ANTIBODIES**
J. Henes, L. Glaesser, L. Kanz, W. Vogel, R. Klein
- P.364** **EFFICACY OF AUTOLOGOUS MICROFAT GRAFT ON FACIAL HANDICAP IN SYSTEMIC SCLEROSIS PATIENTS**
B. Granel, N. Sautereau, A. Daumas, R. Truillet, E. Jouve, J. Magalon, J. Veran, D. Casanova, Y. Frances, F. Sabatier, G. Magalon
- P.365** **DEVELOPMENT OF TOPICAL FORMULATIONS FOR TRANSDERMAL DELIVERY OF VASODILATORS IN RAYNAUD'S PHENOMENON**
A. Gallas, M. Wareing, L.K. Harris, A. Herrick, A.Ch. Hunter
- P.366** **VASODILATING AND VASOACTIVE TREATMENT IN CLINICAL CARE OF SYSTEMIC SCLEROSIS: A REPORT FROM THE DESSCIPHER PROJECT OF THE EUSTAR GROUP**
M. Frerix, L. Cometi, S. Guiducci, F. Del Galdo, G. Abignano, Y. Allanore, J. Avouac, L. Czirják, C. Denton, O. Distler, D. Huscher, V. Lóránd, V.K. Jaeger, B. Maurer, S. Nihtyanova, G. Riemekasten, E. Siegert, S. Vettori, U. Walker, M. Mattucci-Cerinic
- P.367** **WITHDRAWN**
- P.368** **CURRENT IMMUNOSUPPRESSIVE TREATMENT PATTERNS IN ROUTINE CLINICAL CARE OF SYSTEMIC SCLEROSIS: A REPORT FROM THE DESSCIPHER PROJECT OF THE EUSTAR GROUP**
M. Frerix, G. Abignano, Y. Allanore, J. Avouac, L. Czirják, F. Del Galdo, C. Denton, O. Distler, S. Guiducci, D. Huscher, V. Lóránd, V.K. Jaeger, M. Mattucci-Cerinic, B. Maurer, S. Nihtyanova, G. Riemekasten, E. Siegert, S. Vettori, U.A. Walker, U. Müller-Ladner
- P.369** **COMBINATION THERAPY WITH RITUXIMAB AND MYCOPHENOLATE MOFETIL IN SYSTEMIC SCLEROSIS. PRELIMINARY ANALYSIS OF A COHORT OF PATIENTS**
P. Fraticelli, C. Fischetti, L. Manfredi, M. Mattioli, A. Gabrielli
- P.370** **TOCILIZUMAB – A NOVEL PROMISING THERAPY IN SYSTEMIC SCLEROSIS**
A. Duarte, I. Cordeiro, A. Cordeiro, M.J. Santos

- P.371 INTERLEUKIN 6 INHIBITOR TOCILIZUMAB LIMITS TISSUE DAMAGE AND FIBROSIS IN A BLEOMYCIN-INDUCED SCLERODERMA MOUSE MODEL**
S. Donmez, Y. Bozdemir Donmez, M. Erboga, G. Can, M. Kanter, G.E. Pamuk, O.N. Pamuk
- P.372 TYROSINE KINASE INHIBITORS DASATINIB LIMITS TISSUE DAMAGE AND FIBROSIS IN A BLEOMYCIN-INDUCED SCLERODERMA MOUSE MODEL**
Y. Bozdemir Donmez, M. Erboga, S. Donmez, G. Can, G. E. Pamuk, M. Kanter, O. N. Pamuk
- P.373 RIOCIGUAT IN DIFFUSE CUTANEOUS SYSTEMIC SCLEROSIS: RISE-SSC STUDY DESIGN AND RATIONALE**
O. Distler, J. Pope, C. Denton, Y. Allamore, M. Matucci-Cerinic, J. de Oliveira Pena, D. Khanna
- P.374 RITUXIMAB IN SYSTEMIC SCLEROSIS: RESULTS OF A RANDOMIZED PLACEBO CONTROLLED TRIAL**
S. Ben Said-Bouyeri, J. Meijs, N. Ajmone Marsan, A.A. Schouffoer, M.K. Ninaber, F. Bonte-Mineur, H.U. Scherer, T.W.J. Huizinga, J.K. de Vries-Bouwstra
- P.375 CXCL10 CHANGES DURING THERAPIES IN SYSTEMIC SCLEROSIS. AN IN VIVO AND IN VITRO STUDY**
C. Corinaldesi, C. Antinozzi, G. Valesini, K. Stefanantoni, I. Sciarra, V. Riccieri, L. Di Luigi, A. Lenzi, C. Crescioli
- P.376 RITUXIMAB IN THE TREATMENT OF SYSTEMIC SCLEROSIS: THE EXPERIENCE OF OUR TERTIARY REFERRAL RHEUMATOLOGY CENTRE**
D. Giuggioli, M. Colaci, F. Lumetti, C. Ferri
- P.377 THE SAFETY OF RITUXIMAB THERAPY IN SYSTEMIC SCLEROSIS: A SINGLE CENTRE EXPERIENCE**
L. Ananyeva, O. Koneva, O. Desinova, O. Ovsyannikova, A. Volkov, L. Gorzanova, M. Starovoytova

NEW REGISTRY

- P.378 ROLE OF NAILFOLD VIDEOCAPILLAROSCOPY IN DIAGNOSIS AND EVALUATION OF CHINESE SYSTEMIC SCLEROSIS PATIENTS**
D. Xu, Y.F. Zheng, Y. Zheng, Y. Hou, M.T. Li, J.X. Zhou, Q. Wang, X.F. Zeng
- P.379 A PROSPECTIVE STUDY TO IDENTIFY RISK FACTORS FOR PROGRESSIVE CALCINOSIS IN PATIENTS WITH SYSTEMIC SCLEROSIS: CURRENT STATUS AND PRELIMINARY DATA**
A. Valenzuela, J. Gordon, T. S. Rodriguez-Reyna, S. Proudman, V. Hsu, M. Baron, T. A. Medsger Jr., S. Assassi, G. Salazar, M. Hinchliff, D. Fiorentino, D. Khanna, A. Young, B. Kahaleh, F. V. Castelino, S. Schoenfeld, L. Shapiro, S. Lakshminarayanan, L. A. Saketkoo, K. J. Stevens, V. Steen, L. Chung
- P.380 NAILFOLD CAPILLAROSCOPY IN CONNECTIVE TISSUE DISEASES - A SINGLE CENTER EXPERIENCE**
L. Teixeira, I. Cordeiro, J. Canas da Silva, M. José Santos, A. Cordeiro
- P.381 AUTOIMMUNE/INFLAMMATORY SYNDROME INDUCED BY ADJUVANTS – A CASE REPORT ABOUT SILICON-INDUCED SYSTEMIC SCLEROSIS**
P. Silva, R. Malheiro, S. Pinheiro
- P.382 OCULAR INVOLVEMENT AND GENITAL MUCOSA LESIONS IN A MALE TEENAGER WITH SYSTEMIC SCLEROSIS – A RARE ASSOCIATION**
M. Salgado, L. Theilacker, J. Vaz, F. Freire, S. Francisco, F. Bandeira, D. Sogui
- P.383 CANCER INCIDENCE IN PATIENTS WITH SYSTEMIC SCLEROSIS IN THE STATE OF RIO DE JANEIRO – BRAZIL**
M. Salgado, S. Merenlender, J. Vaz, F. Freire, D. Sogui, L. Theilacker
- P.384 SYSTEMIC SCLEROSIS IN CLINICAL PRACTICE: 2013 AMERICAN COLLEGE RHEUMATOLOGY/EUROPEAN LEAGUE AGAINST RHEUMATISM CLASSIFICATION CRITERIA VERSUS 1980 ARA/ACR CLASSIFICATION CRITERIA**
M. Rodrigues, C. Costa, D. Jesus, M. Santiago, P. Carvalho, J. Ferreira, A. Daniel, G. Eugénio, A. Malcata, J.A.P. da Silva, M.J. Salvador

- P.385 CONCORDANCE OF NEW 2013 ACR/EULAR AND 1980 ACR CRITERIA FOR THE CLASSIFICATION OF SYSTEMIC SCLEROSIS**
M.E. Lara, M.M. Mayer, G. Gómez, L. González Lucero, V.L. Cosentino, I.A. Veltri, A. Lizarraga, M. Khoury, M. Rivero, M.V. Collado, M. Machado Escobar, S.F. Montoya, E.M. Baldessari, J. Sarano, M.S. Yacuzzi, E.M. Kerzberg, M. Landi, H.Laborde, J.C. Barreira
- P.386 INCIDENCE, PREVALENCE AND FIVE-YEAR SURVIVAL OF SYSTEMIC SCLEROSIS (SSC) IN SPLIT-DALMATIA COUNTY**
M. Radic, M. Cikes, I. Bozic, J. Borovac, K. Boric, D. Martinovic Kaliterna
- P.387 IRANIAN SYSTEMIC SCLEROSIS REGISTRY**
S. Poormoghim, R. Talebi, M. Amiri, E. Andalib
- P.388 SCLERODERMA RENAL CRISIS AND SEVERE VASCULOPATHY IN ANA NEGATIVE SSC PATIENT- A CASE REPORT**
A. Petcu, R. Nichitean, I. R. Dobrota, S. Rednic
- P.389 USEFULNESS OF THE EUSTAR PRELIMINARY CRITERIA FOR VERY EARLY SYSTEMIC SCLEROSIS AND LE ROY CRITERIA FOR EARLY-SYSTEMIC SCLEROSIS IN IDENTIFYING PATIENTS AT RISK OF DEVELOPMENT OF SYSTEMIC SCLEROSIS**
F. Ortiz Sanjuán, C. Alcañiz Escandell, K. Arévalo Ruales, I. Chalmeta Verdejo, C. Fedec Olmos, J. Frago Gil, L. González Puig, E. Labrador Sánchez, I. Martínez Cordellat, R. Negueroles Albuixech, J. L. Valero Sanz, E. Grau García, J. Ivorra Cortés, C. Núñez-Cornejo Piquer, J. A. Román Ivorra
- P.390 AUTOANTIBODY AND CLINICAL PROFILE OF SSC PATIENTS IN A SINGLE CENTER – RETROSPECTIVE ANALYSIS**
J. Milas-Ahic, V. Prus, Z. Kardum, I. Kovacevic
- P.391 MYOPATHY ASSOCIATED WITH SSC – A JOINT EUSTAR-SCTC SUB-COHORT INITIATIVE**
B. Maurer, R. Dobrota, V. Jaeger, L. Chung, V. Hsu, U.A. Walker, O. Distler
- P.392 REGISTRIES IN SCLERODERMA, DATA FROM THE PORTUGUESE NATIONAL REGISTRY R.I.D.A.I.– PART I**
J. Matos Costa, I. Almeida, J. Delgado Alves, S. Pinheiro, L. Santos, M. Santos, G. Alves, H. Brito, N. Oliveira, J. Vedes, P. Ferreira, J. Garcia, A. Marinho
- P.393 SYSTEMIC SCLEROSIS OVERLAP SYNDROMES: A PARTICULAR SUBSET OF SYSTEMIC SCLEROSIS PATIENTS**
T. Martins Rocha, R. Fonseca, F. Aguiar, D. Rosa-Goncalves, T. Meirinhos, A. Bernardo, M. Bernardes, L. Costa
- P.394 SYSTEMIC SCLEROSIS – POPULATION OF AN INTERNAL MEDICINE DEPARTMENT**
M. Marques Silva, R. Ribeiro, C. Costa, P. Silva, L. Câmara, J. Oliveira, R. Malheiro, P. Barreto, R. Estriga, S. Galego, S. Pinheiro
- P.395 PANNICULITIS ASSOCIATED WITH A NEURO BEHCET : A CASE REPORT**
B. Mahdi, S. Sayhi, F. Laajili, R. Abid, R. Battikh, B. Louzir, N. Ben Abdelhafidh, S. Othmani
- P.396 INFLUENCE OF ANTIBODY PROFILE IN CLINICAL FEATURES AND PROGNOSIS IN A SPANISH COHORT OF SYSTEMIC SCLEROSIS**
N. Iniesta, G. Espinosa, V. Fonollosa, D. Colunga, N. Ortego, M. Rubio, J.A. Vargas, L. Trapiella, M. Rodríguez-Carballeira, C.P. Simeón
- P.397 SENSITIVITY AND SPECIFICITY OF THE 2013 ACR/EULAR CLASSIFICATION CRITERIA FOR SYSTEMIC SCLEROSIS IN JAPANESE PATIENTS WITH EARLY SYSTEMIC SCLEROSIS**
Y. Ikawa, N. Mugii, T. Matsushita, Y. Hamaguchi, K. Takehara
- P.398 SCLERODERMA CLINICAL TRIALS CONSORTIUM GASTROINTESTINAL WORKING GROUP**
T. Frech, Z. McMahan, G. Piemonte, M. Matucci-Cerinic, S. Proudman, D. Khanna
- P.399 PERFORMANCE OF THE EULAR/ACR 2013 CLASSIFICATION CRITERIA IN A PORTUGUESE SYSTEMIC SCLEROSIS POPULATION**
A. Fonseca, D. Rosa-Gonçalves, F. Aguiar, T. Martins-Rocha, T. Meirinhos, E. Mariz, M. Bernardes, L. Costa
- P.400 THE RARE DISEASES COLLECTOR**
C. Costa, J. Oliveira, S. Pinheiro
- P.401 REUMA.PT/SCL – THE PORTUGUESE REGISTRY FOR SCLERODERMA PATIENTS**
A. Cordeiro, C. Ponte, M. Couto, I. Cordeiro, M.J. Salvador, F. Araújo, P. Clemente-Coelho, M. Eusébio, F. Martins, M.J. Santos
- P.402 CHARACTERISTICS OF PATIENTS WITH SYSTEMIC SCLEROSIS IN QATAR**
S. Al-Emadi, F. Alam , I. Ul Haq , P. Chandra, H. Abdulaziz

GENERAL INFORMATION



Congress Venue

Lisbon Congress Center
Praça das Indústrias
1300-307 Lisboa, Portugal

How to get to the congress venue

Travel from Cais do Sodré (following bus and tram) to the Lisbon Congress Centre (station name: R. Junqueira/Centro de Congressos):
Bus 732: Marquês Pombal/Outurela
Tram 15E: Alçgs/Praça da Figueira

Following buses are also available from the station R. Junqueira/Centro Congressos:

Bus 714: Praça da Figueira / Outurela
Bus 727: Estação Roma-Areeiro / Restelo – Av. Descobertas
Bus 751: Estação Campolide / Linda-a-Velha
Bus 756: Olaias / R. Junqueira

Subway

Take the blue Line from the Marques de Pombal metro station to Terreiro do Paço metro station and there catch the tram n° 15. Or take the blue Line until Cais do Sodre and there catch the tram n° 15. Stop at the R. Junqueira/Centro de Congressos

Organizing Secretariat

AIM Group International
AIM Congress – Florence Office
Viale G. Mazzini, 70 – 50132 Florence, Italy
Tel. +39 055 233881 – Fax +39 055 2480246
ssc2016@aimgroup.eu

Onsite the registration desk will be open for participants at the following times: *Thursday, February 18* from 11:30 to 20:00, *Friday, February 19* from 07:30 to 18:30 and *Saturday, February 20* from 07:30 to 17:00

REGISTRATION FEES (VAT incl.)	
Physicians	€ 830,00
Young Investigators* / Fellows	€ 365,00
PhD Basic Scientists	€ 365,00
HP (Nurses and Physiotherapists)	€ 365,00
Medical Students**	€ 240,00
Patients	€ 35,00

* For young doctors under 30 years of age. Copy of the ID or passport is requested.

** These individuals must include a letter from their program director, chief of service or faculty advisor to be eligible for reduced fees.

GENERAL INFORMATION

Registration fees include:

Congress kit, access to the scientific sessions, admission to the exhibition and poster area, certificate of attendance, coffee breaks and working lunches as indicated in the programme and abstracts book, online subscription for one year to “Journal of Scleroderma and Related Disorders”.

Registration fee for patients includes:

Congress kit, access to the Opening Ceremony of the medical congress, scientific sessions of the patient congress only, coffee breaks and working lunch as indicated in the patient programme.

Congress badges

Each participant may collect the badge at the registration desk. Participants are kindly requested to wear their badge during all congress activities and social events.

No colour: Participants

Red colour: Invited Speakers and Chairpersons

Yellow colour: Exhibitors

Blue colour: Patients

Internet connection

Free wi-fi connection is available in all congress spaces except in the poster area.

Wifi: SSC2016

Password: SSC2016

Language

The official language is English.

Catering

Coffee breaks

Coffee breaks will be organized in the exhibition area, first floor, Hall 4, during the following times:

Friday, February 19

from 10:40 to 11:00 and from 16:55 to 17:15

Saturday, February 20

from 10:20 to 10:40

Lunches

A standing buffet lunch will be offered to all registered participants on *Friday, February 19* from 13:45 to 14:45 and on *Saturday, February 20* from 12:40 to 13:30 in exhibition area, first floor, hall 4.

Certificate of Attendance

Certificates of attendance will be available on request starting from *Saturday, February 20* at the Registration desk.

Exhibition

An exhibition will be open in the following days at Hall 4 at the first floor: *Thursday, February 18* from 15:00 to 19:30, *Friday, February 19* from 08:00 to 19:00, *Saturday, February 20* from 08:00 to 13:30.

Social Programme

Welcome Cocktail – Thursday, February 18

A welcome cocktail will be held after the Opening Ceremony in the foyer at the first floor for all registered participants.

Congress Dinner – Friday, February 19

The seated Congress Dinner with buffet service will be held at “**Pateo Alfacinha**”, Rua do Guarda Joias, 44. Informal evening with typical Portuguese menu.

Transfer by bus, upon reservation, will be provided from the Congress Center at 19:30. For those who want to reach Pateo Alfacinha on their own the evening will start at 19:50. Remaining tickets will be sold to the “New registration” desk until Friday, February 19 at 10:00.

EXHIBITION FLOORPLAN

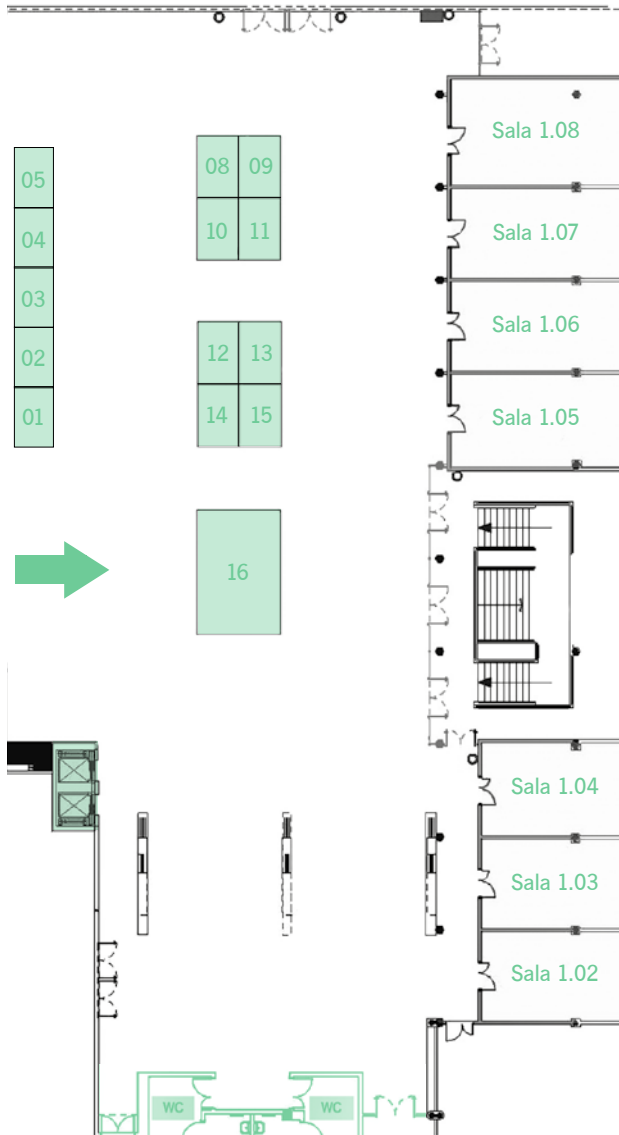

Space nr.	Company
01	Therakos
02	Optilia Instruments
03	Cytori Therapeutics
04	DS Medica
05	World Scleroderma Foundation, EUSTAR Journal of Scleroderma & Related Diseases
8,9,10,11	GlaxoSmithKline
12,13,14,15	Bayer
16	Actelion

CONGRESS SPACES FLOORPLAN

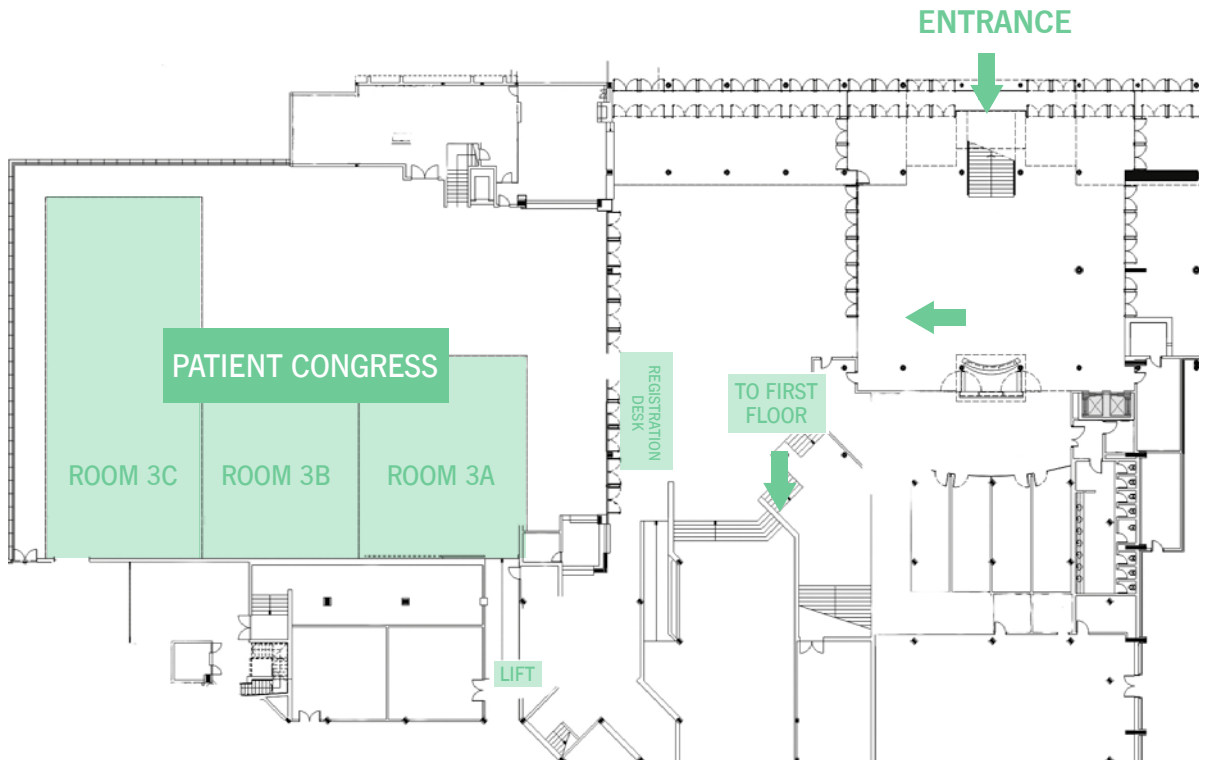

GROUND FLOOR

CONGRESS SPACES FLOORPLAN

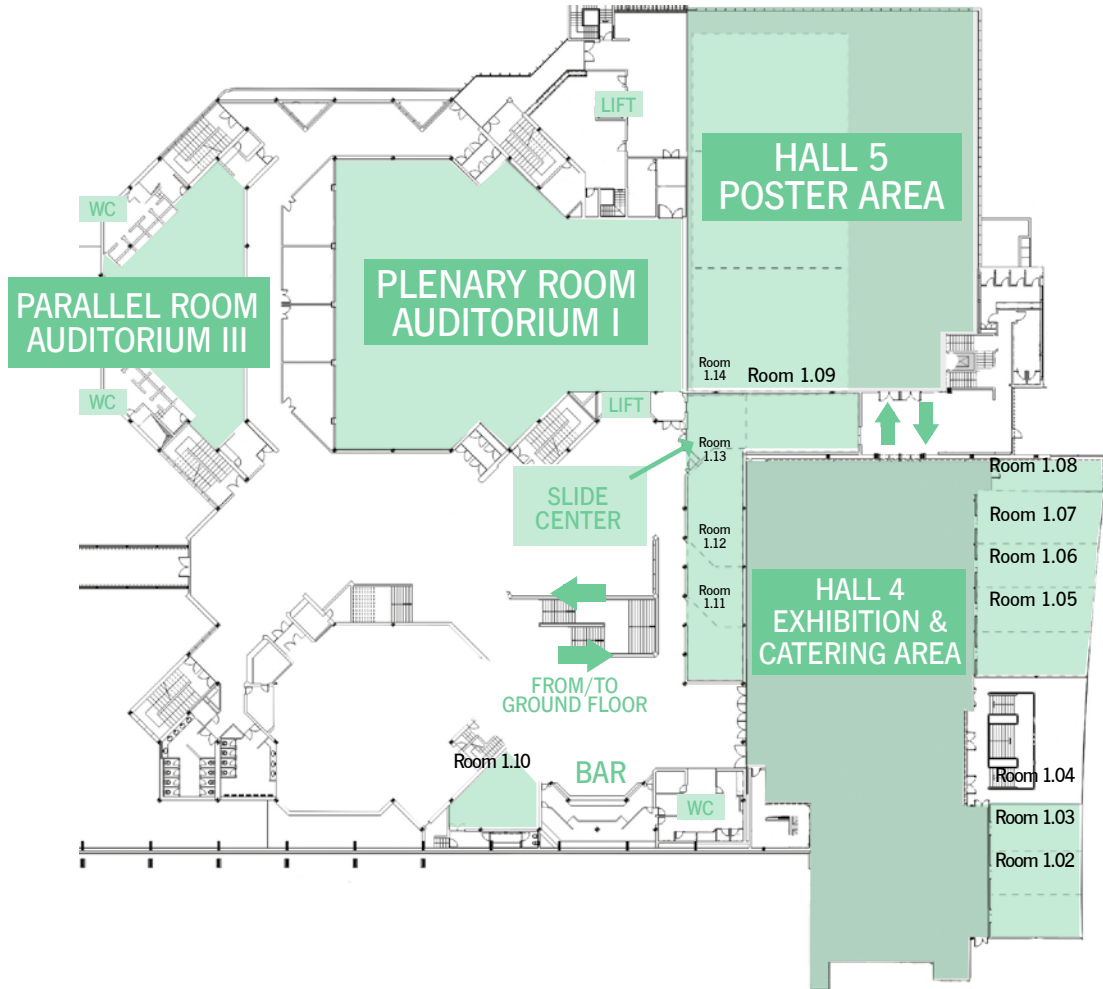

FIRST FLOOR

SCIENTIFIC INFORMATION



Abstract sessions

Selected papers will be orally presented by the Authors. Authors have the time indicated in the programme including the discussion.

Poster Session

Poster session will take place in the Poster Area at the first floor on *Friday, February 19* from 13:45 to 14:45 and on *Saturday, February 20* from 12:40 to 13:30. Authors have been given a number and must be fixed on the poster board marked with the same number. Posters can be hanged from 15:00 to 18:00 of *Thursday, February 18* and from 07:45 of *Friday, February 19* and removed within 17:00 of *Saturday, February 20*.

Poster panel height is cm 215 and the usable surface in vertical size is cm. 90 (wide) and cm. 135 (height).

Authors are kindly asked on Friday 19 and Saturday 20 to stand by their poster during the Poster Session time for discussion with delegates. Otherwise please hang a note to inform when you will be available.

Meet the Professors session

Meet the Professors sessions will be organized on *Saturday, February 20* from 08:00 to 09:00 (see the scientific program) for young practicing physicians only, for a maximum of 20 participants each, on first come, first served basis. Remaining places can be booked at the "New registration" desk.

Slide Center

The Slide Center is available in the room 1.14 at the first floor. Speakers are kindly requested to load their slides in the Slide Center at least three hours before their presentation (or, if their session starts at 8:00, by 18:00 on the previous day).

The opening hours of the slide center are: *Thursday, February 18*, from 11:30 to 19:00, *Friday, February 19* from 07:30 to 18:30 and *Saturday, February 20*, from 07:30 to 16:00.

Abstract book

The abstracts of the oral presentations and posters are included in the **Journal of Scleroderma and Related Disorders** in the congress bag.

ACKNOWLEDGEMENTS



The Congress Organisers gratefully acknowledge support received from all exhibitors and the following sponsors:

Platinum Sponsor:



Other Sponsors:



Gold Sponsors:



The patient congress is supported by:



Silver Sponsor:



Organizing Secretariat



AIM Group International

Florence Office

Viale G. Mazzini, 70

50132 Florence, Italy

ph. +39 055 233881

fax +39 055 2480246

ssc2016@aimgroup.eu

www.sscworldcongress.org